

# MILPASS

s.r.l.

**Costruzione protezioni  
antifortunistiche per  
macchine automatiche**

***Construction of safety  
guards for automatic  
machines***

**Construction équipements  
protection contre les accidents  
pour machines automatiques**

**Catalogo Generale  
*General Catalogue*  
Catalogue Général**

**Linea STRUTTURALE  
*STRUCTURAL Line***





MILPASS

PROFILATI ESTRUSI IN ALLUMINIO ANODIZZATO (cava 8)  
ANODISED EXTRUDED ALUMINIUM PROFILES (slot: 8)

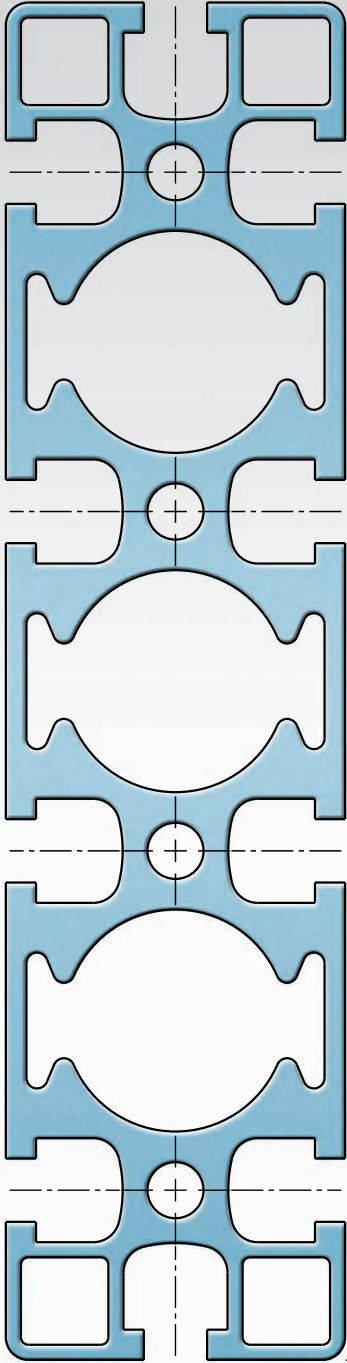
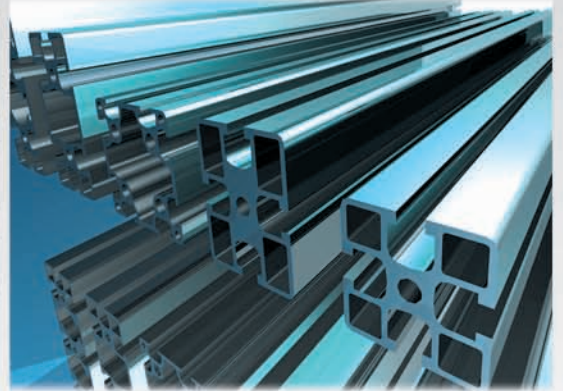
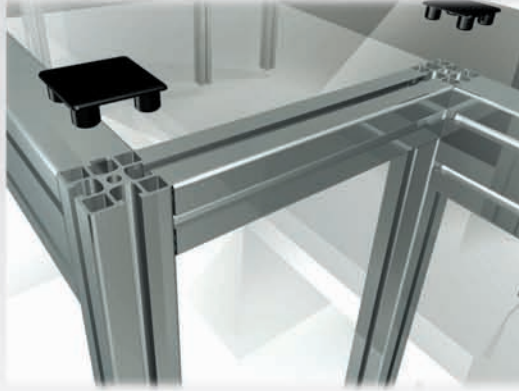

Code SA01006

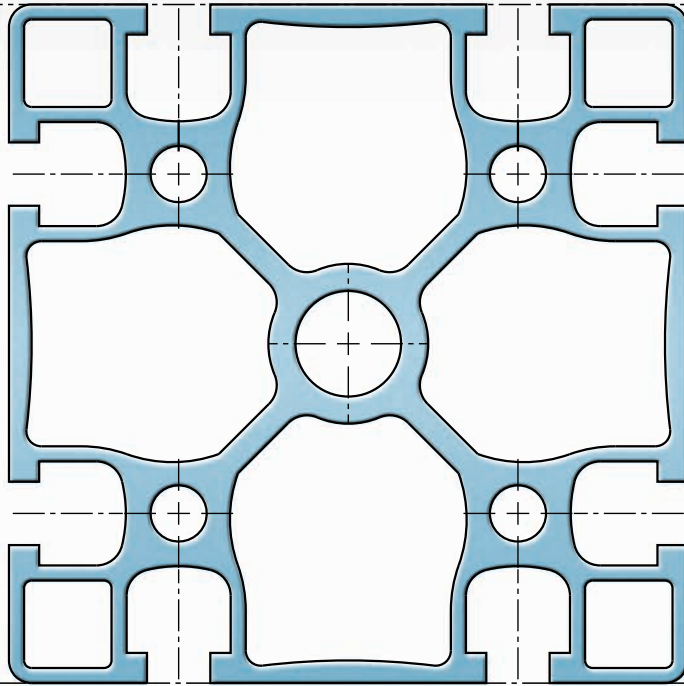

Code SA01004

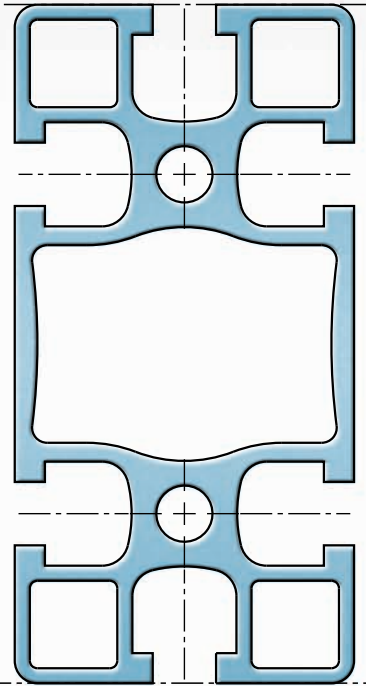

Code SA01003

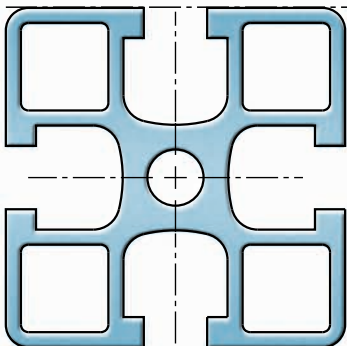

Code SA01001

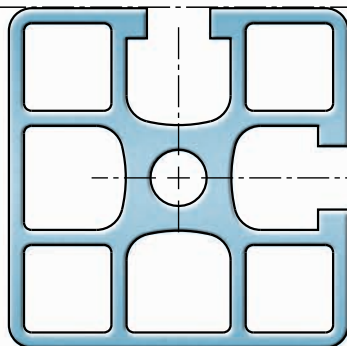

Code SA02005

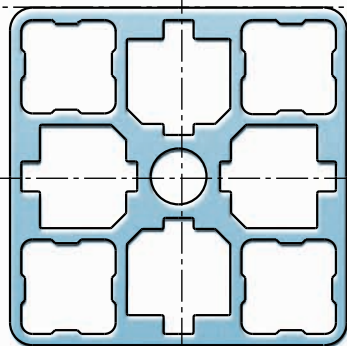

Code SA03001

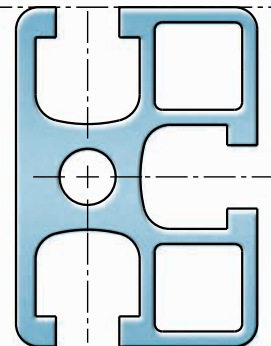

Code SA02004

MILPASS presenta la sua linea di **profili strutturali**, un'ottima alternativa alle tradizionali carpenterie in ferro per la versatilità e le caratteristiche del sistema stesso:

- sezioni studiate per velocizzare gli assemblaggi
- completezza degli accessori
- un rapporto tempo/lavoro non eguagliabile con altri materiali
- finiture esteticamente curate senza particolari lavorazioni aggiuntive (nessuna saldatura o verniciatura)
- massima modularità ed adattabilità per i progettisti
- perfetta integrazione con le nostre protezioni, con i sistemi di automazione, movimentazione o imballaggio in genere

I nostri profili ed i relativi accessori sono utilizzabili in ogni settore in cui è richiesta la progettazione di:

- strutture portanti
- tavoli da lavoro
- nastri trasportatori per linee di confezionamento o convogliamento
- sistemi automatizzati
- linee di montaggio
- strutture complesse in genere

I profili possono essere forniti in barre o tagliati a misura per commesse rilevanti.

I nostri reparti di montaggio, inoltre, possono realizzare l'assemblaggio di qualsiasi struttura richiesta da nostro o Vostro progetto.

MILPASS presents its line of **structural profiles**, the ideal alternative to traditional iron structural systems because of the system's versatility and excellent features:

- sections designed to speed up assembly and installation
- completeness of the range of accessories
- a time/work ratio which cannot be matched using other materials
- lovely finishes without any need for extra work (no welding or painting)
- total modularity and adaptability for the designers
- perfect integration with our protections/guards and with automation, movement, handling and packaging systems in general

Our profiles and relative accessories can be used in any sector which requires the design of:

- support structures
- work tables
- conveyor belts for packaging or conveyor lines
- automated systems
- assembly lines
- complex structures in general

The profiles can be supplied in bars or cut to size for big orders.

Our assembly departments can also assemble any structure required by our/your design details.

180

90

60

0

45

32

0

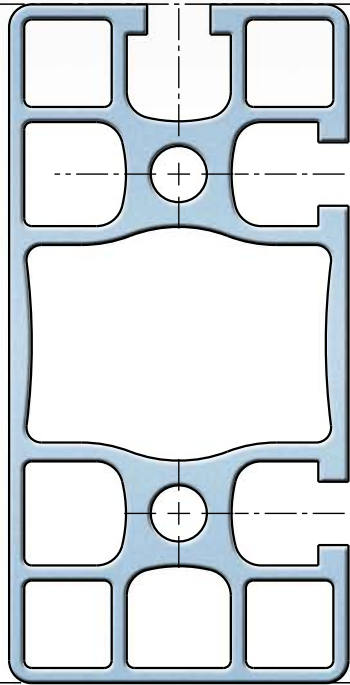

Code SA02006

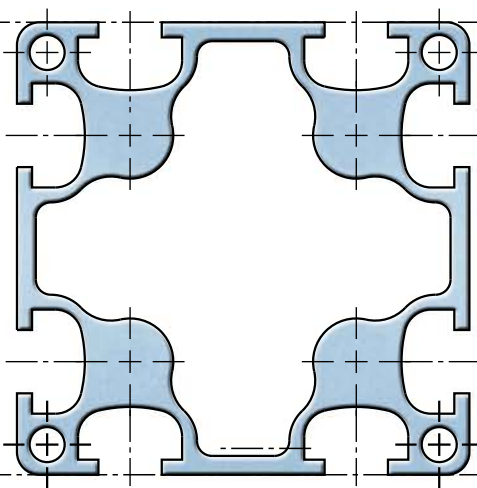

Code SA01005

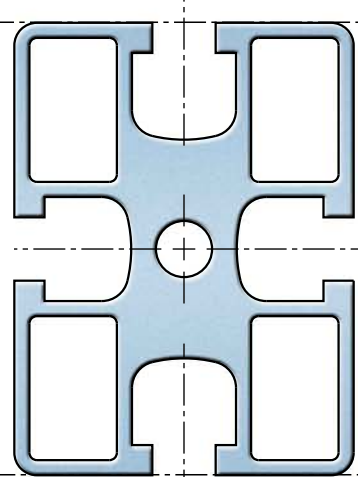

Code SA01002

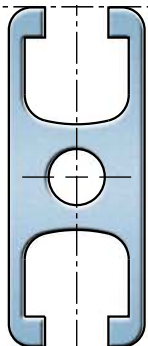

Code SA02002

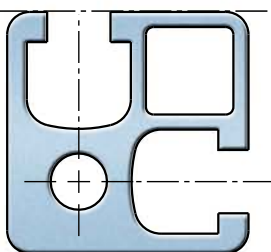

Code SA02003

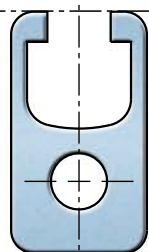

Code SA02001

**PROFILI ESTRUSI IN ALLUMINIO, cava 8 mm a profilo aperto o semichiuso**

**Materiali e caratteristiche:**

- Lega di alluminio Al Mg 0,5 Si 0,4 Fe UNI 9006/1
- Trattamento superficiale in anodizzazione anodica 10-15 micron
- Lunghezza barre, 6100 mm

**Caratteristiche meccaniche:**

- Carico unitario di rottura a trazione Rm, 250 N/mm<sup>2</sup>
- Carico unitario di scostamento della proporzionalità Rp 0,2, 200 N/mm<sup>2</sup>
- Allungamento, 10%
- Durezza Brinnel, 70HB

**Caratteristiche fisiche:**

- Massa volumica, 2,7 Kg/dm<sup>3</sup>
- Punto di fusione inferiore, circa 605 °C
- Modulo di elasticità, 70.000 N/mm<sup>2</sup>

**EXTRUDED ALUMINIUM PROFILES, slot 8 mm with profile open or semi-closed**

**Materials and characteristics:**

- Aluminium alloy Al Mg 0.5 Si 0.4 Fe UNI 9006/1
- Surface treatment in anodic anodizing 10-15 micron
- Bar length, 6100 mm

**Mechanical characteristics:**

- Ultimate tensile strength Rm, 250 N/mm<sup>2</sup>
- Proportionality deviation strength Rp 0.2, 200 N/mm<sup>2</sup>
- Elongation, 10%
- Hardness Brinnel, 70HB

**Physical characteristics:**

- Volume mass, 2.7 Kg/dm<sup>3</sup>
- Lower melting point, approx. 605 °C
- Modulus of elasticity, 70,000 N/mm<sup>2</sup>



**PROFILI ESTRUSI IN ALLUMINIO (scala 1:2,5)**

45 x 180

Code SA01006

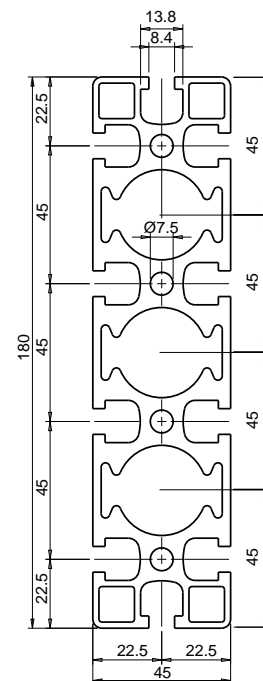
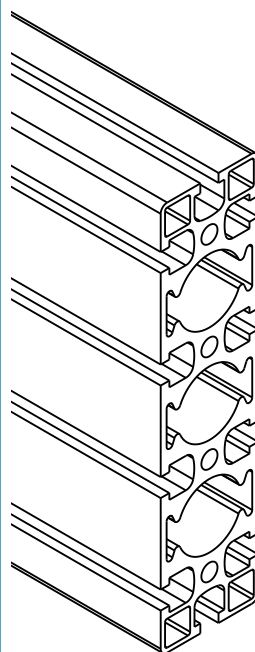

90 x 90

Code SA01004

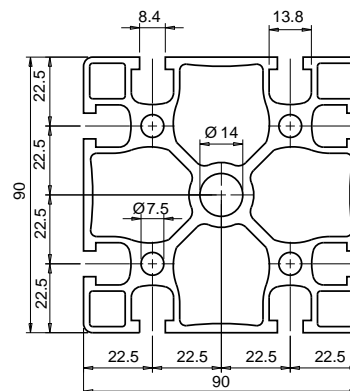
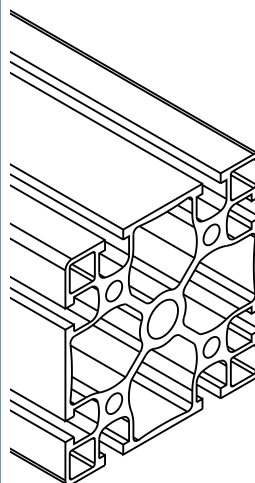

45 x 45

Code SA03001

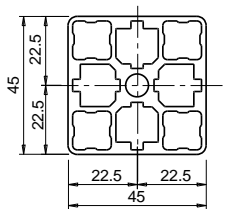
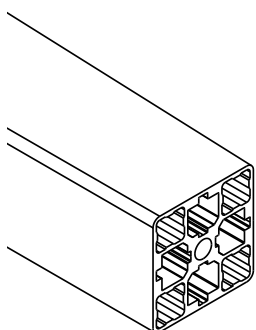

45 x 90

Code SA01003

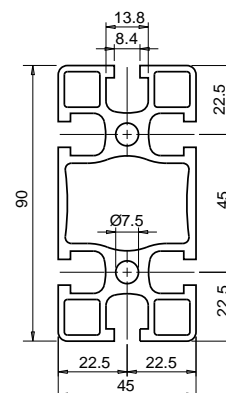
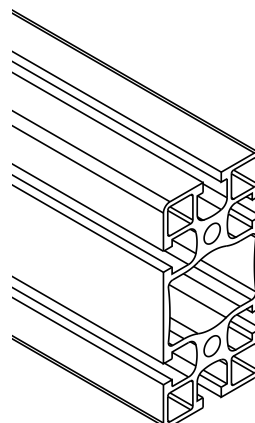



45 x 90

Code SA02006

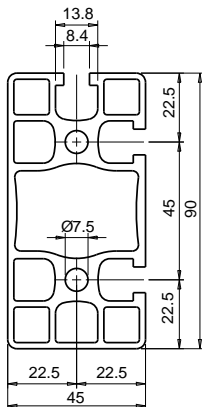
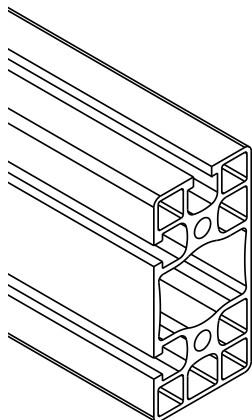

45 x 45

Code SA02005

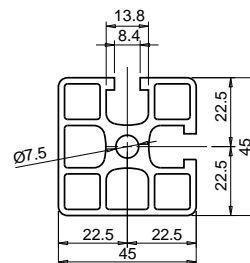
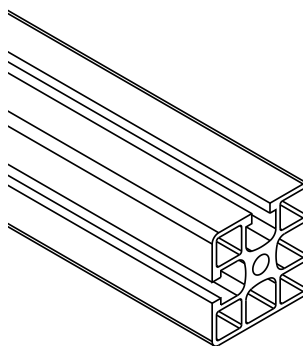

60 x 60 (cava ribassata/lowered slot)

Code SA01005

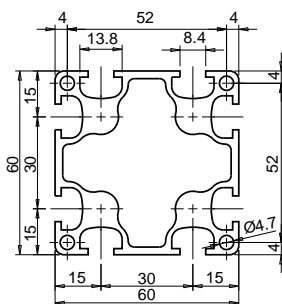
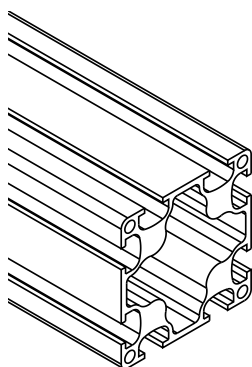

32 x 45

Code SA02004

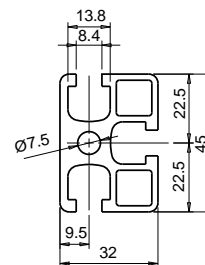
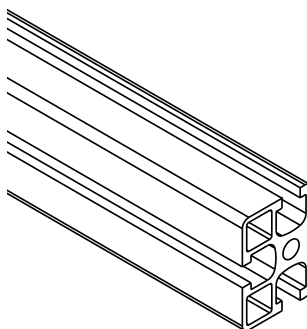

45 x 60

Code SA01002

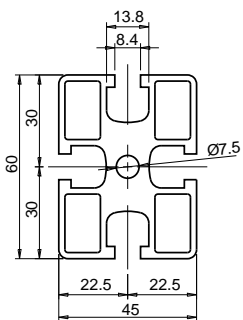
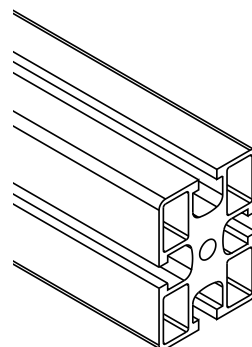

32 x 32

Code SA02003

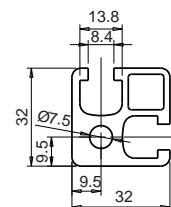
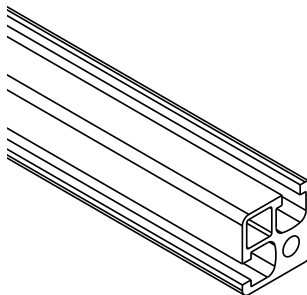

45 x 45

Code SA01001

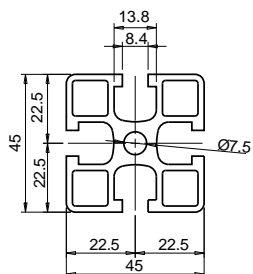
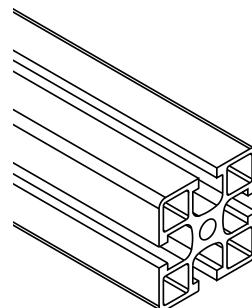

18 x 45

Code SA02002

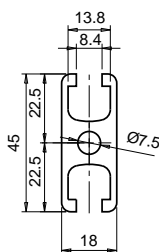
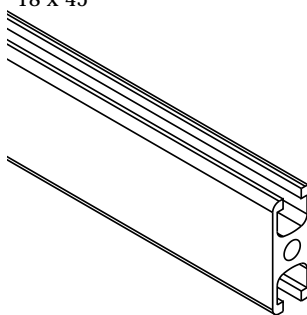

18 x 32

Code SA02001

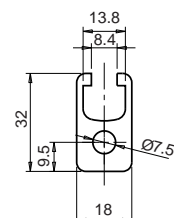
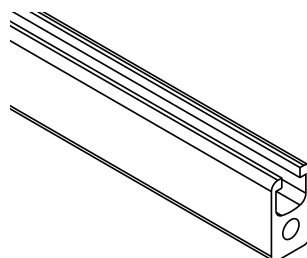

## Cuffie e profili di chiusura

Tutti i materiali vengono prodotti in poliammide "6" con materiale rinforzato a fibre di vetro.

**Struttura:** materiale termoplastico parzialmente cristallino

**Colore:** nero

### Caratteristiche meccaniche:

elevata resistenza alla fatica, resistenza all'usura e all'urto

Caratteristiche termiche:

VICAT (punto di rammollimento) 215 °C

### Resistenza a:

idrocarburi, benzina, oli e grassi, soluzioni alcaline in genere.

Buona resistenza all'invecchiamento

### Installazione:

si innestano sui profili con una semplice pressione e senza l'utilizzo di colla

## Casings and closure profiles

All materials are made of polyamide "6" with fibreglass reinforced material.

**Structure:** partially crystalline thermoplastic material

**Colour:** black

### Mechanical characteristics:

high resistance to fatigue, wearproof and shock resistant

Thermal characteristics: VICAT (softening point) 215 °C

### Resistance to:

hydrocarbons, petrol, oils and greases, alkaline solutions in general.

Good resistance to ageing

### Installation:

simply press to couple to profiles, no glue required



## CUFFIE E PROFILI DI CHIUSURA CASINGS AND CLOSURE PROFILES



Code SL01009

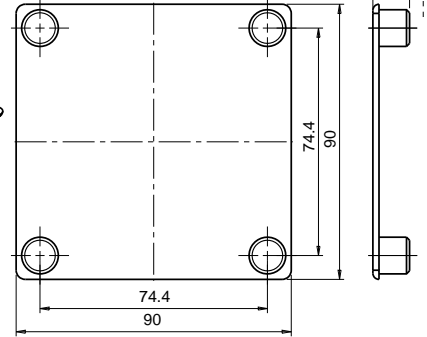
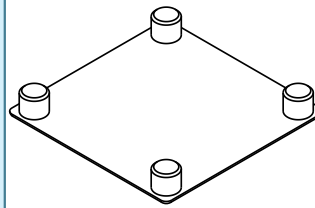

Code SL01008

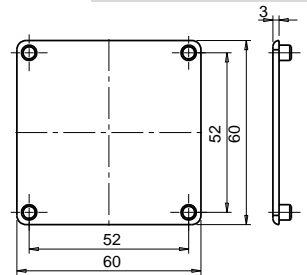
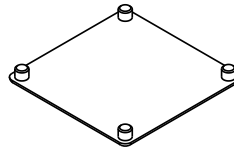

Code SL01007

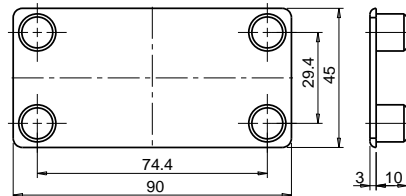
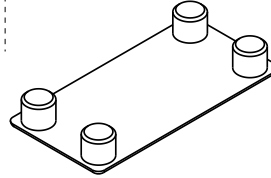

Code SL01006

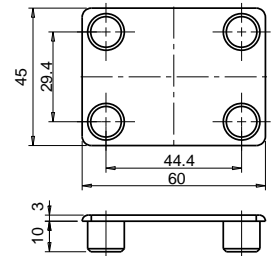
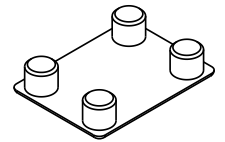

Code SF05001

Code SF05000

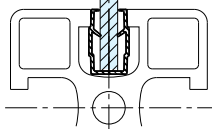
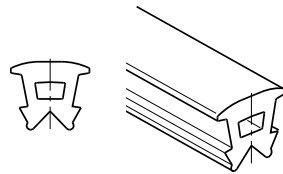
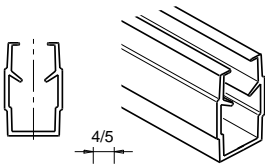

Esempio di utilizzo per lastre  
Sheets use example

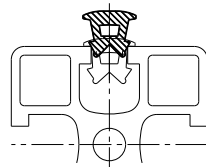

Profilo copricava morbido  
Sheets use example

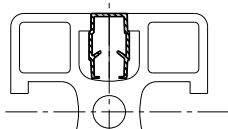

Esempio di utilizzo come copricava  
Copricava use example

Code SL01010

Code SL01011

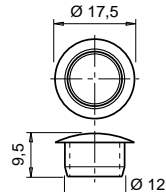
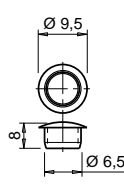

Code SL01005

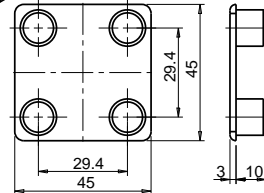
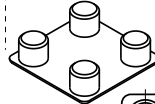

Code SL01004

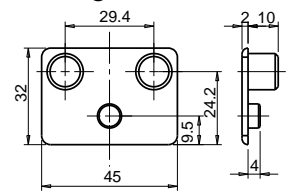
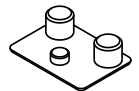

Code SL01003

Code SL01002

Code SL01001

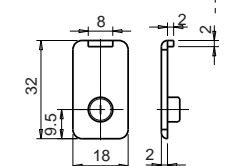
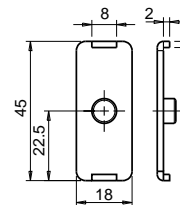
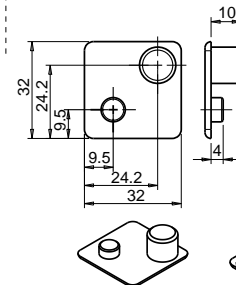

## Dadi, rondelle, viti

Tutti gli elementi di fissaggio sono in acciaio zincato.  
I dadi, nella versione normale o anticaduta, sono predisposti per essere inseriti nelle cave dei profili a struttura montata.

## Nuts, washers, screws

All fastening elements are made of galvanized steel.  
The nuts, in the normal or self-locking version, are prepared to be inserted in the profile slots once the structure is assembled.



## ELEMENTI DI FISSAGGIO FASTENING ELEMENTS



Code  
SF01001 (M4)  
SF01002 (M5)  
SF01003 (M6)  
SF01004 (M8)

Code  
SF01005 (M4)  
SF01006 (M5)  
SF01007 (M6)  
SF01008 (M8)

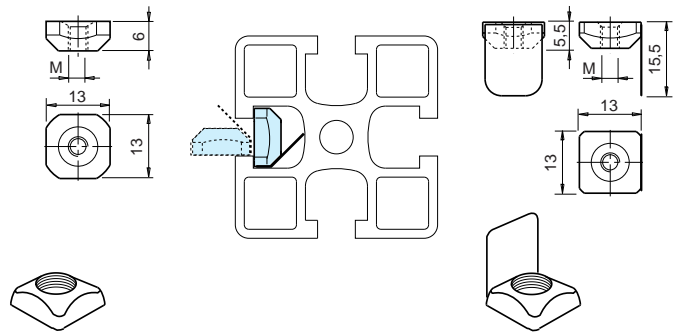

Code SF01012 (L 25)

Code SF01016 (L 42)

Code SF01017

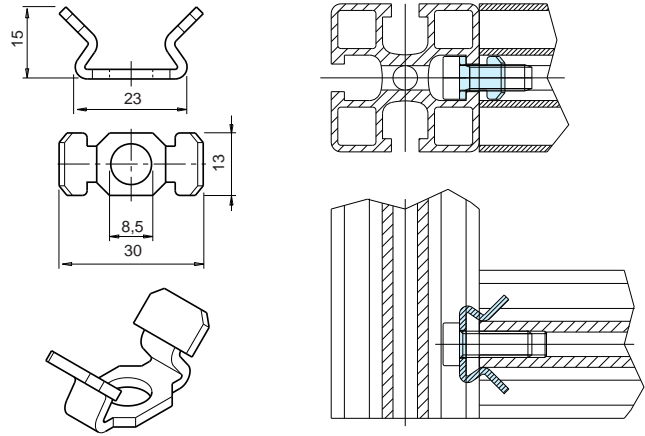
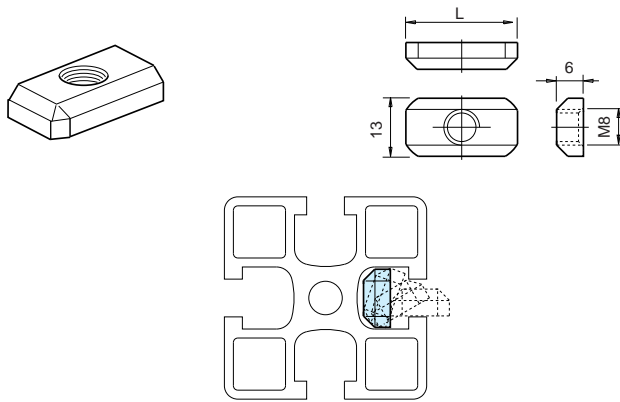

Code SF01025

Code SF02002

Code SF02001

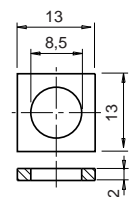
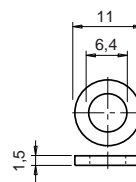
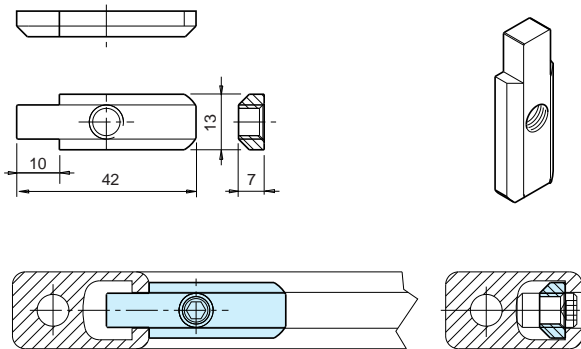

Code  
SF03001 (M8 x 16)  
SF03002 (M8 x 20)  
SF03003 (M8 x 22)  
SF03004 (M8 x 45)

Code  
SF04001 (M8 x 25)

Code F11093

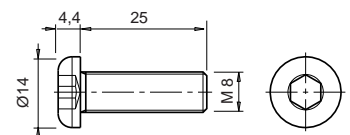
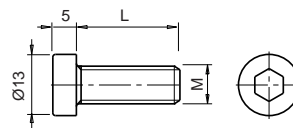
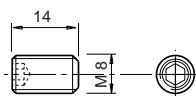

## Elementi di giunzione

### Materiali e caratteristiche:

- Lega di alluminio EN AB - Al Si 11 Cu2Fe "EN AB46100"
- Trattamento superficiale, nessuno
- Tutti i particolari sono burattati

### Caratteristiche meccaniche:

- Carico unitario di rottura a trazione Rm, 265-295 N/mm<sup>2</sup>
- Carico al limite di snervamento, 155-199 N/mm<sup>2</sup>
- Allungamento, 1-2%%
- Durezza Brinell, 85-100 HB

### Caratteristiche fisiche:

- Massa volumica, 2,7 Kg/dm<sup>3</sup>
- Punto di fusione inferiore, circa 505 °C
- Modulo di elasticità, 74.500 N/mm<sup>2</sup>

## Joint elements

### Materials and characteristics:

- Aluminium alloy EN AB - Al Si 11 Cu2Fe "EN AB46100"
- Surface treatment, none
- All parts are tumbled

### Mechanical characteristics:

- Ultimate tensile strength Rm, 265-295 N/mm<sup>2</sup>
- Load at yield point, 155-199 N/mm<sup>2</sup>
- Elongation, 1-2%%
- Hardness Brinell, 85-100 HB

### Physical characteristics:

- Volume mass, 2.7 Kg/dm<sup>3</sup>
- Lower melting point, approx. 505 °C
- Modulus of elasticity, 74,500 N/mm<sup>2</sup>

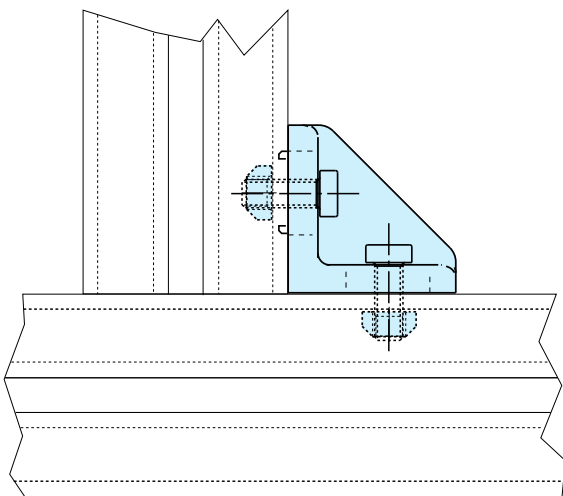

## ELEMENTI DI GIUNZIONE JOINT ELEMENTS

Code SL03005

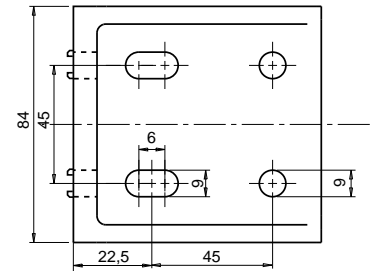
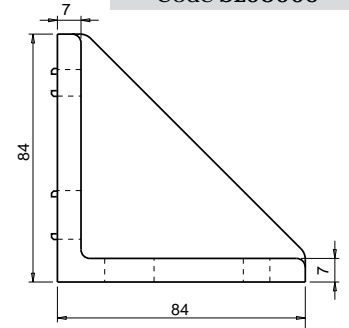
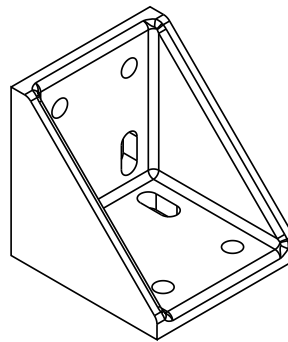

Code SL03004

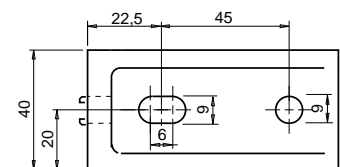
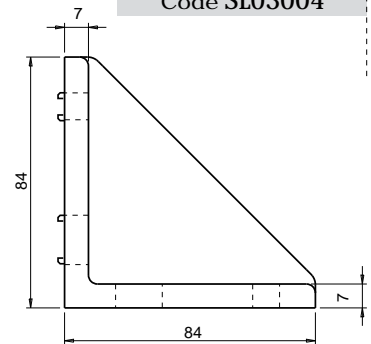
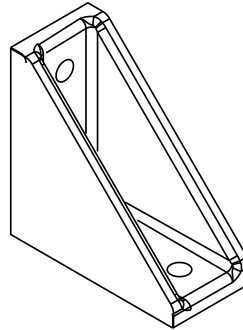

Code SL03003

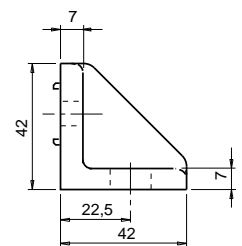
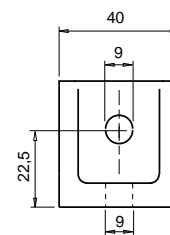
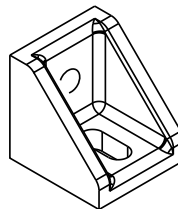

Code SL03002

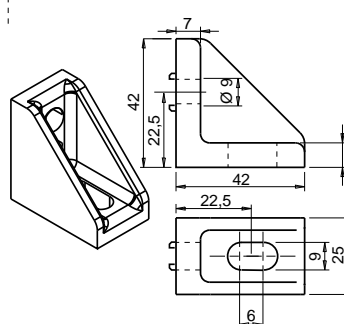

Code SL03001

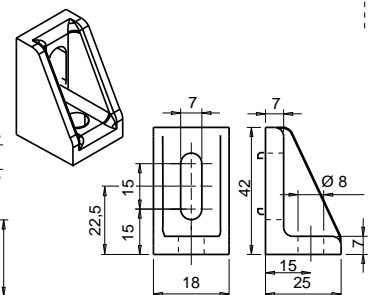



Code SF01020

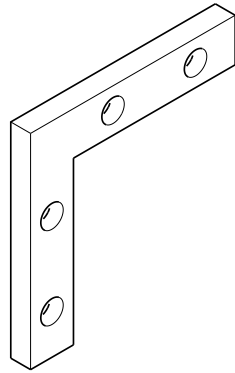
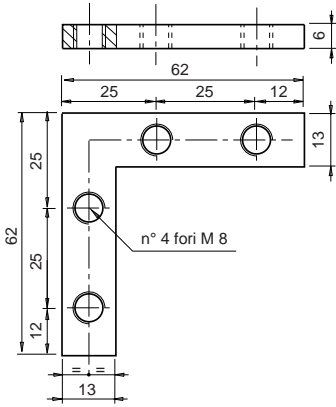

Code SF01023

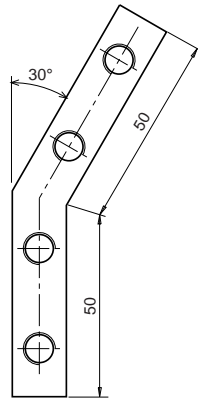

Code SF01021

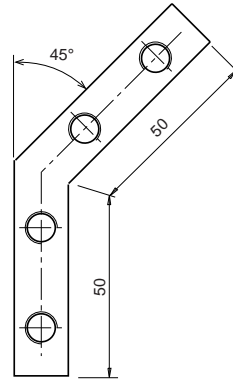

Code SF01024

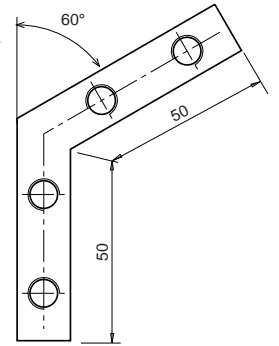

Code SF01022

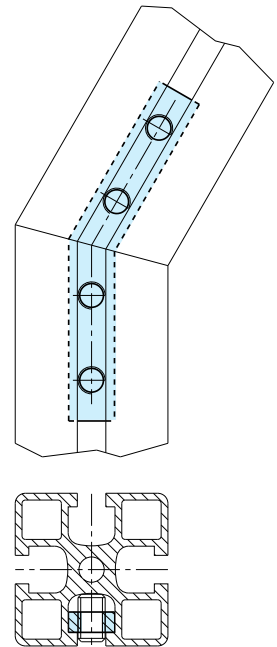
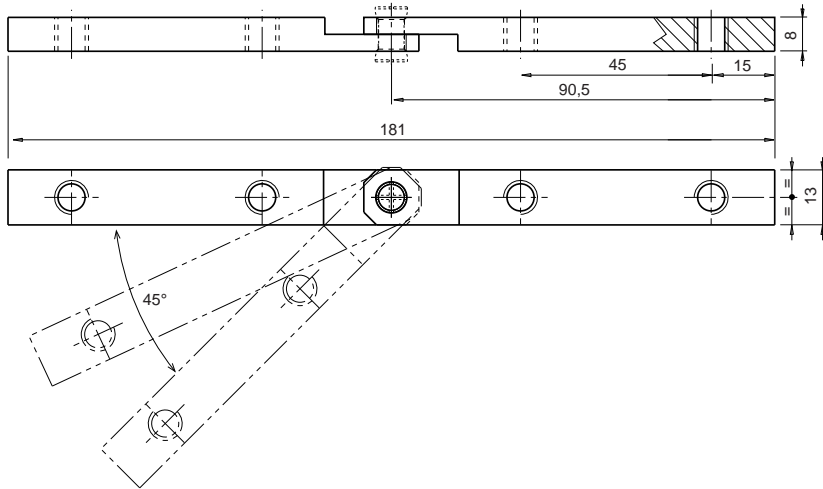

Code SF01018

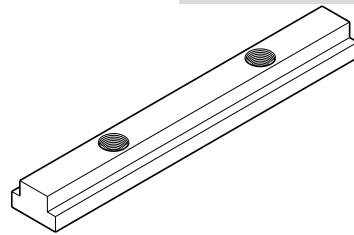
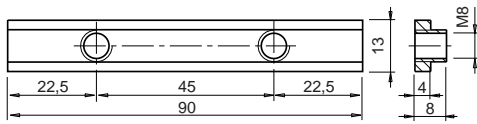

Code SN05001

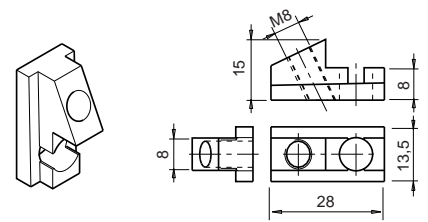

Code SF01019

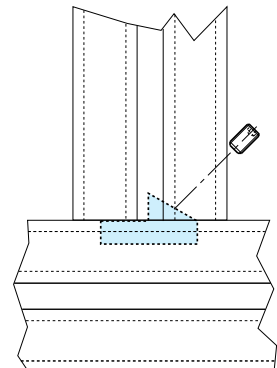
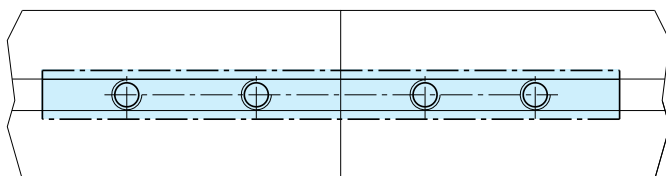
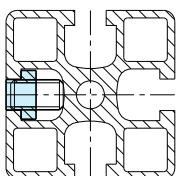
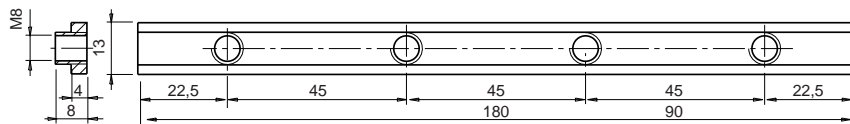

## Elementi di sostegno e accessori

### Piedi:

- Base di appoggio realizzata in poliammide rinforzato
- La versione antivibrazione è dotata di un fondello in gomma resistente all'olio (durezza 70 Shore)

### Piastre per fissaggio piedi:

- In alluminio (lega Al Mg 0,5 Si 0,4 Fe UNI 9006/1)
- Trattamento superficiale: anodizzazione

### Basi di appoggio:

- In acciaio verniciate RAL 9007

## Support elements and accessories

### Feet:

- Support base made of reinforced polyamide
- The vibration-dampening version is fitted with an oil-resistant rubber base (hardness 70 Shore)

### Plates for fastening feet:

- Aluminium (alloy Al Mg 0.5 Si 0.4 Fe UNI 9006/1)
- Surface treatment: anodizing

### Support base:

- Painted steel RAL 9007



## ELEMENTI DI SOSTEGNO E ACCESSORI SUPPORT ELEMENTS AND ACCESSORIES

Code F21812

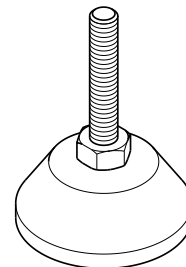
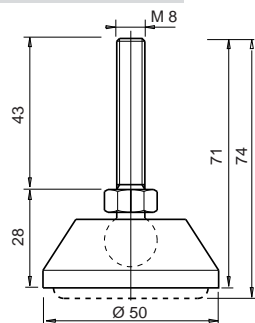

Code F21813

L	L1	L2	A	E	D	Ø
97	100	70	27	13	80	9

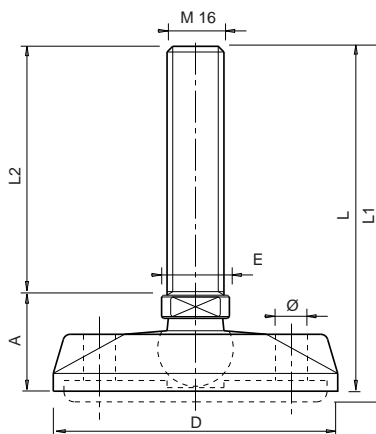

Code F21814

L	L1	L2	A	E	D	Ø
102	105	55	47	20	100	12,5

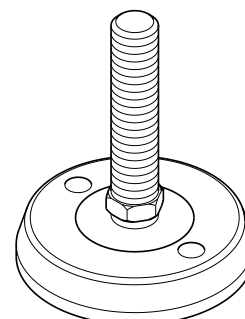

Code F21816

L	L1	L2	A	E	D	Ø
160	163	115	45	24	100	12,5

Code SL02001

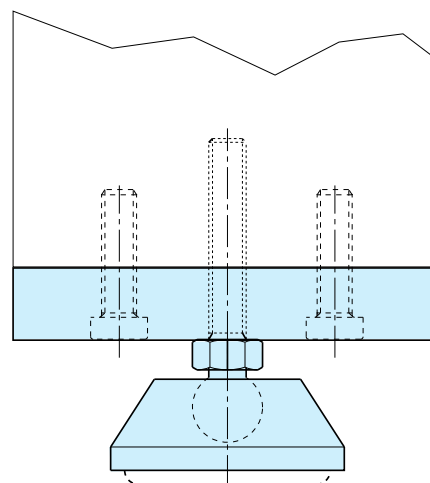
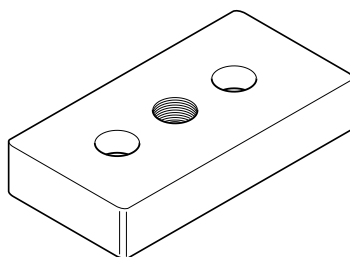
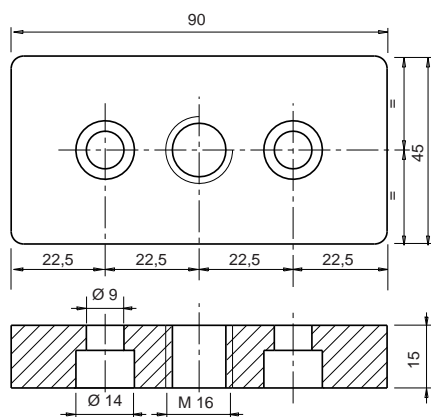

Code SL02002

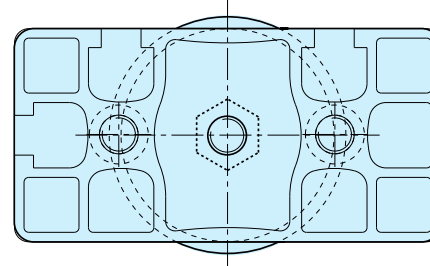
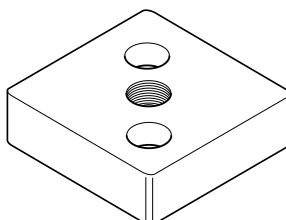
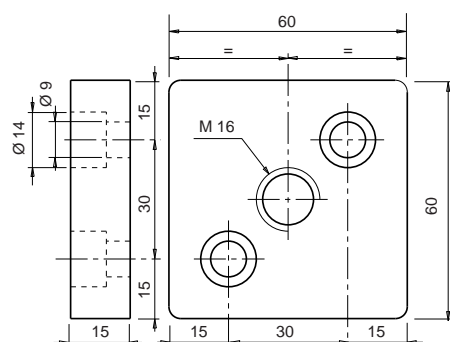



Code SN04001

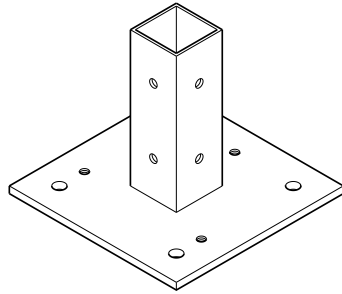
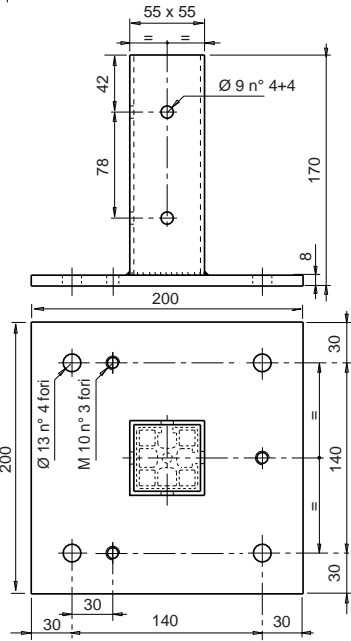

Code SN04002

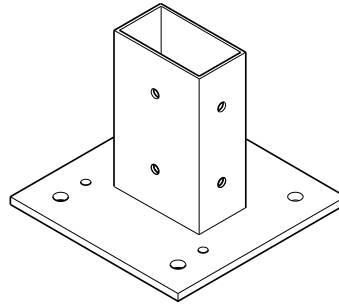
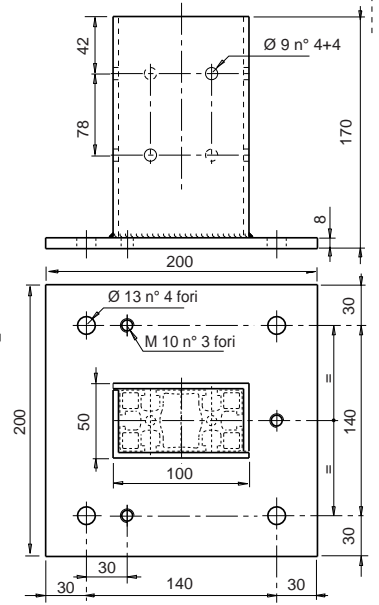

Code SN04003

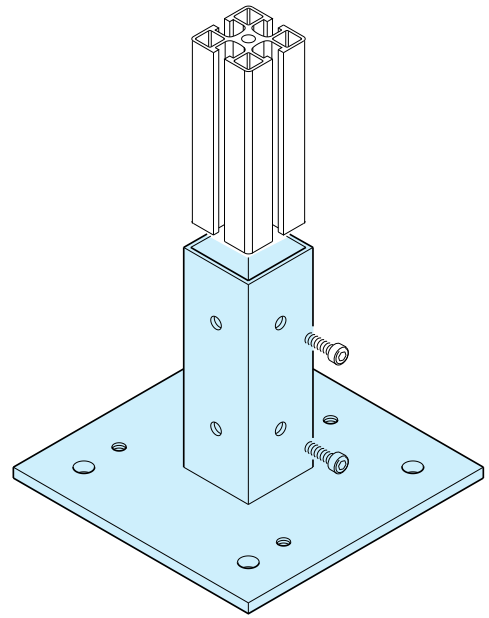
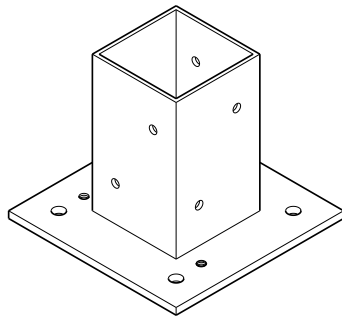
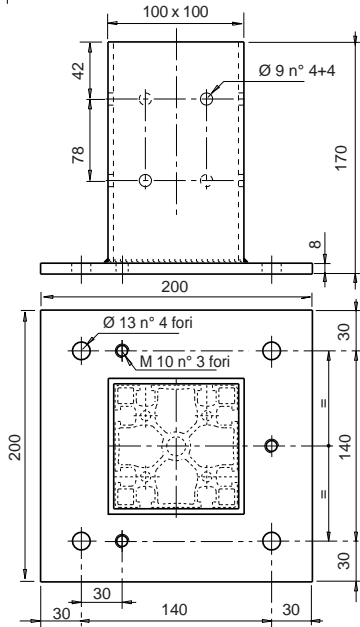

Code SN04004

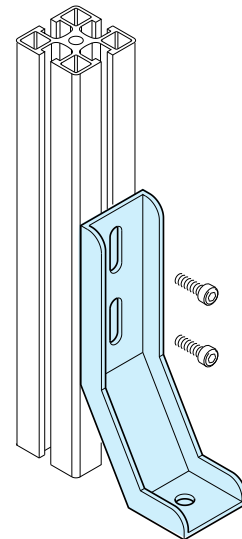
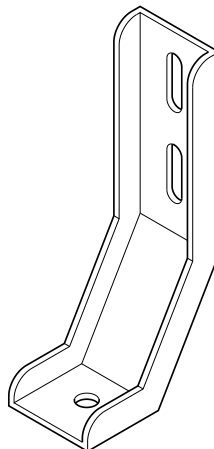
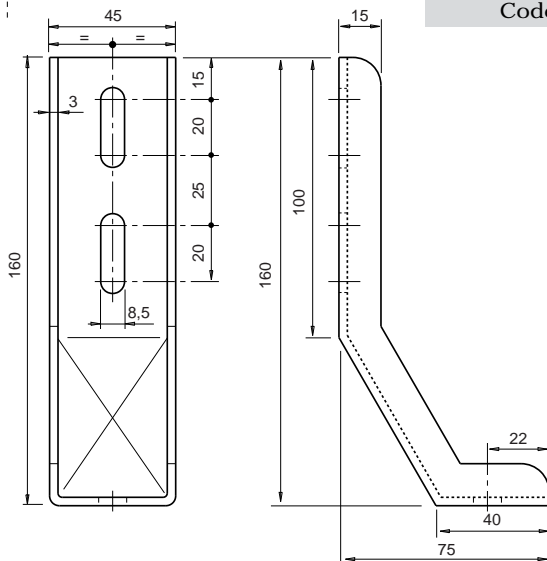

## Accessori di completamento

### Cerniere:

- In alluminio (Al Mg 0,5 Si 0,4 Fe UNI 9006/1)
- Trattamento superficiale: anodizzazione

### Supporti:

- In poliammide "6" rinforzato a fibre di vetro

### Tamponamenti e accessori:

- In gomma sintetica, colore nero

## Range of accessories

### Hinges:

- Aluminium (Al Mg 0.5 Si 0.4 Fe UNI 9006/1)
- Surface treatment: anodizing

### Supports:

- Polyamide "6" fibreglass reinforced

### Buffers and accessories:

- Synthetic rubber, black



## ACCESSORI DI COMPLETAMENTO RANGE OF ACCESSORIES

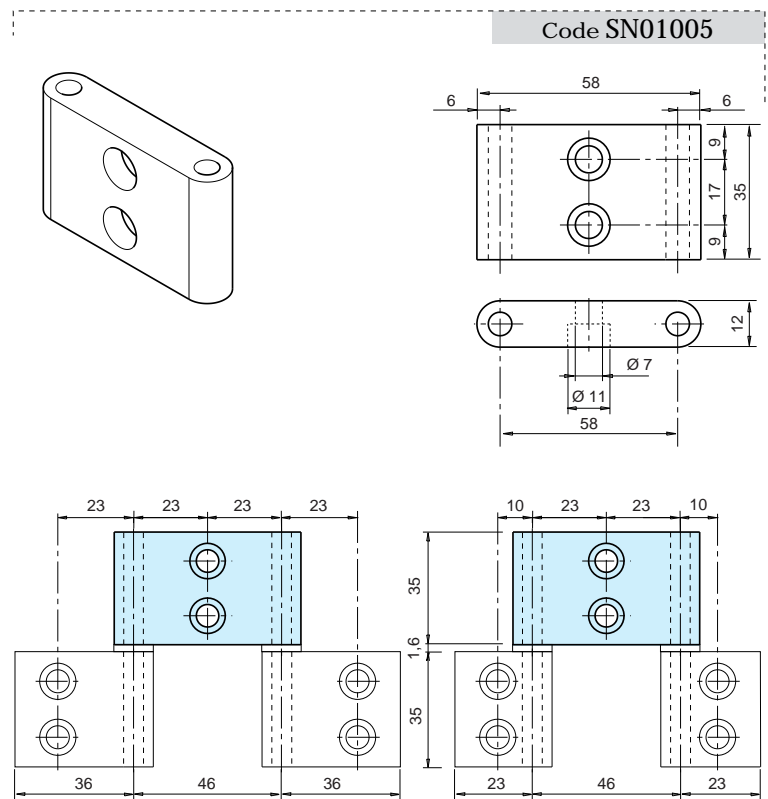

Code SN01001

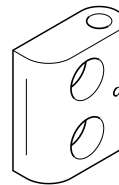
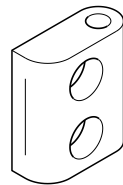
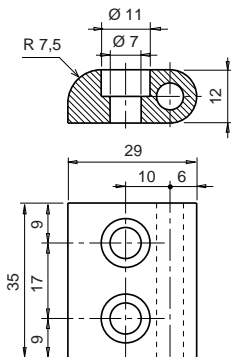

Code SN01003

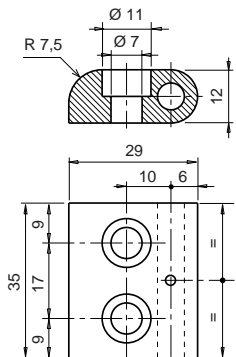

Code SN01002

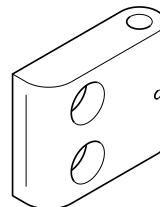
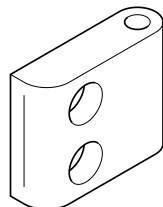
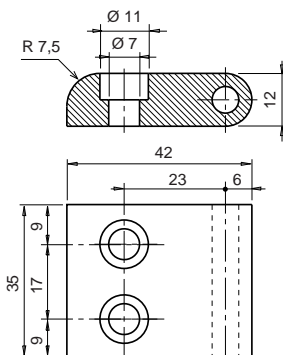

Code SN01004

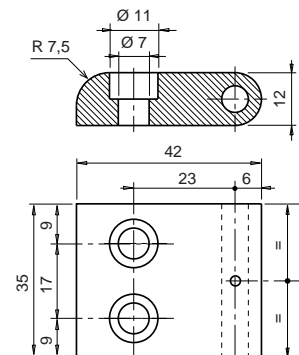

Code SN02001

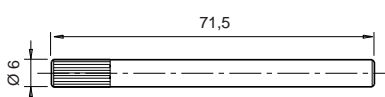

Code SF02002

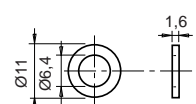



Esempi di assemblaggio semicerniere  
 Examples of semi-hinge assembly

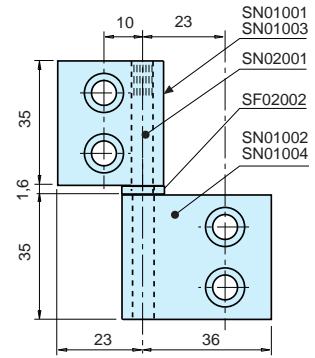
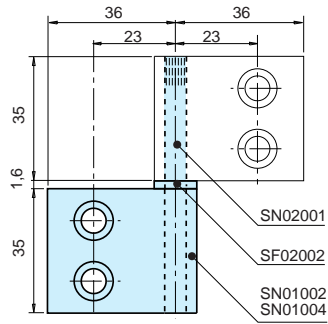
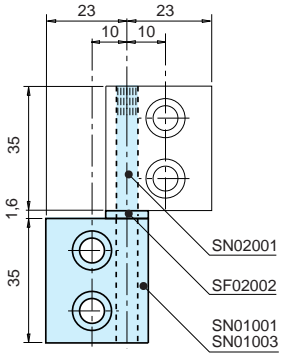

Code SL04001

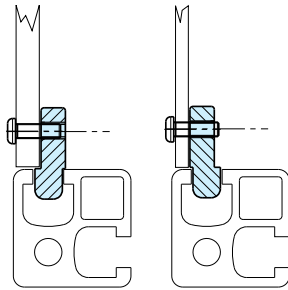
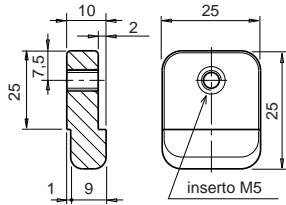
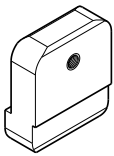

Code SL04002

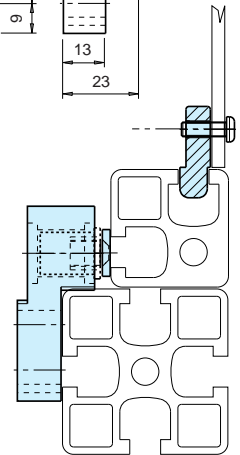
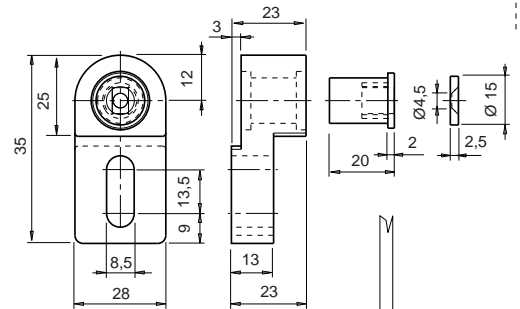
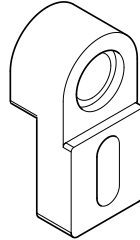

(1 DX + 1 SX)

Code SL4003

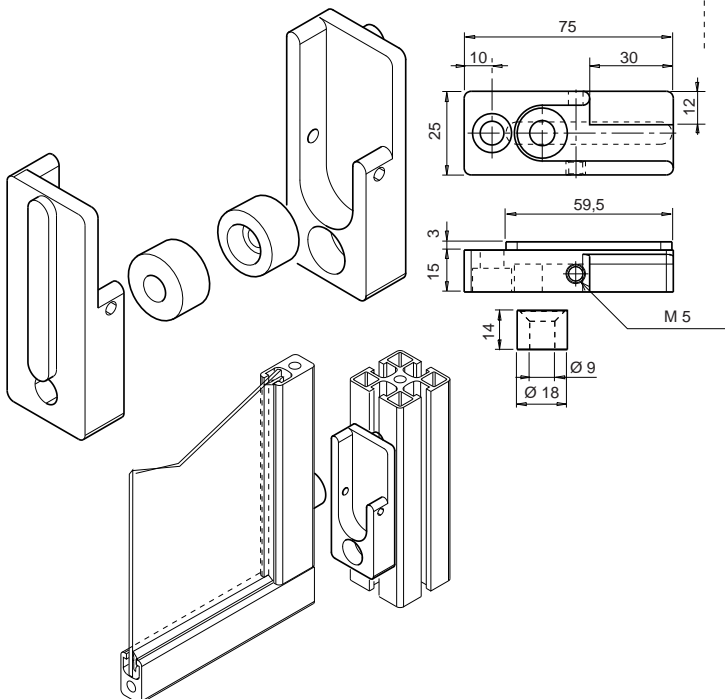

S	A	B	C	D	Code
1,5	12,32	12,5	8,9	9,5	SF05002
3	10,32	12,5	7,9	9,5	SF05003
4	9,32	12,5	5,9	9,5	SF05004
5	8,32	12,5	4,9	9,5	SF05005

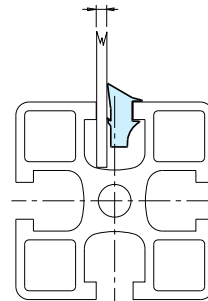
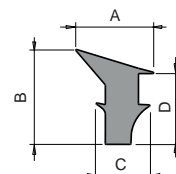

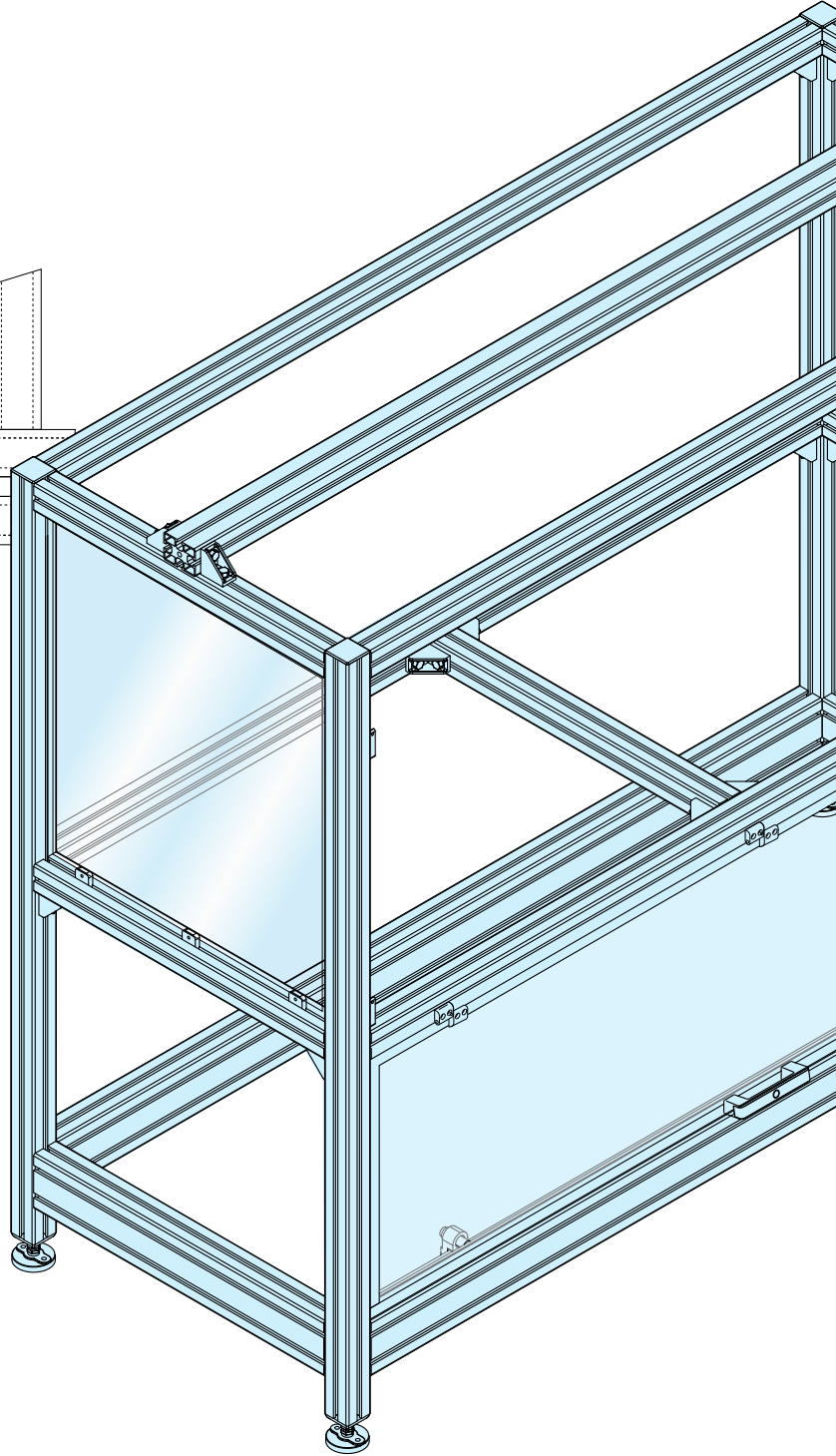
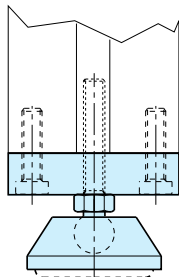
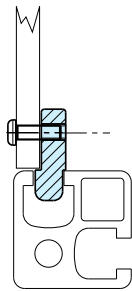
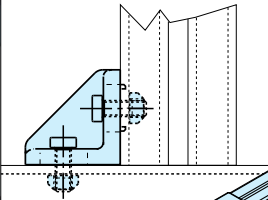
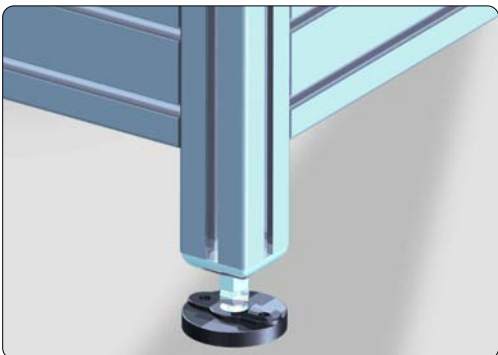
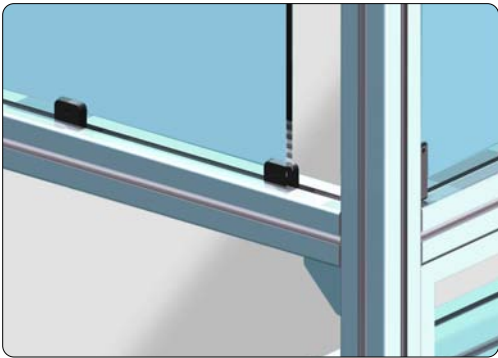
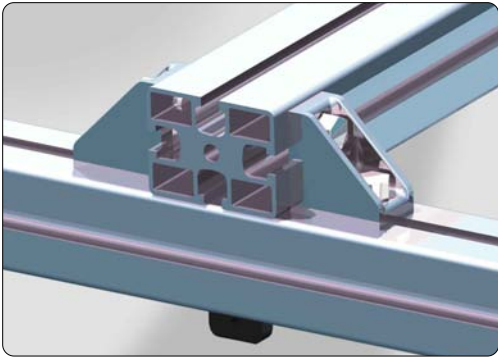
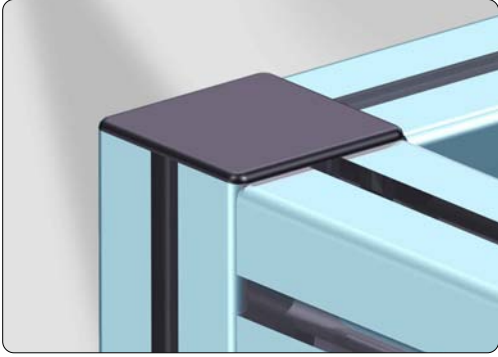

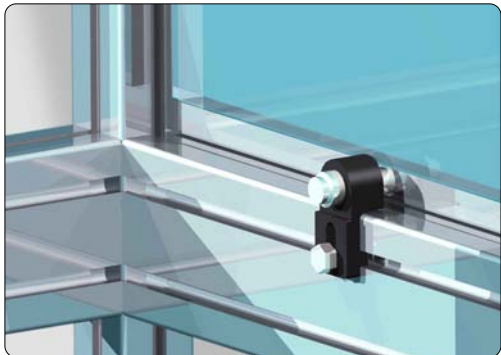
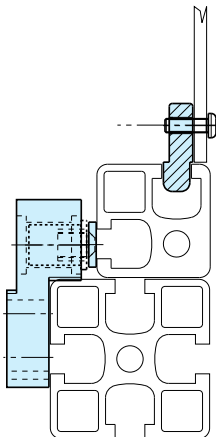
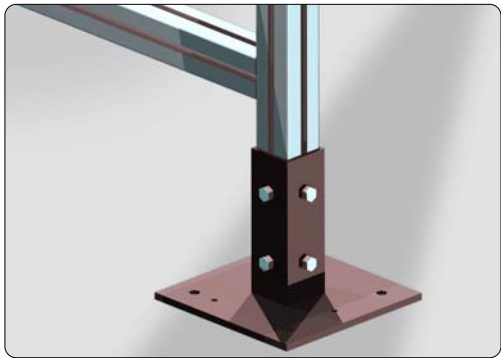
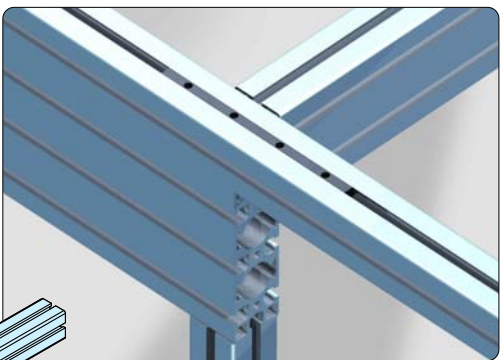
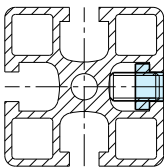
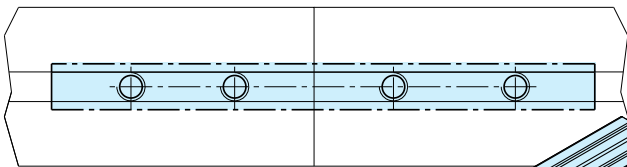
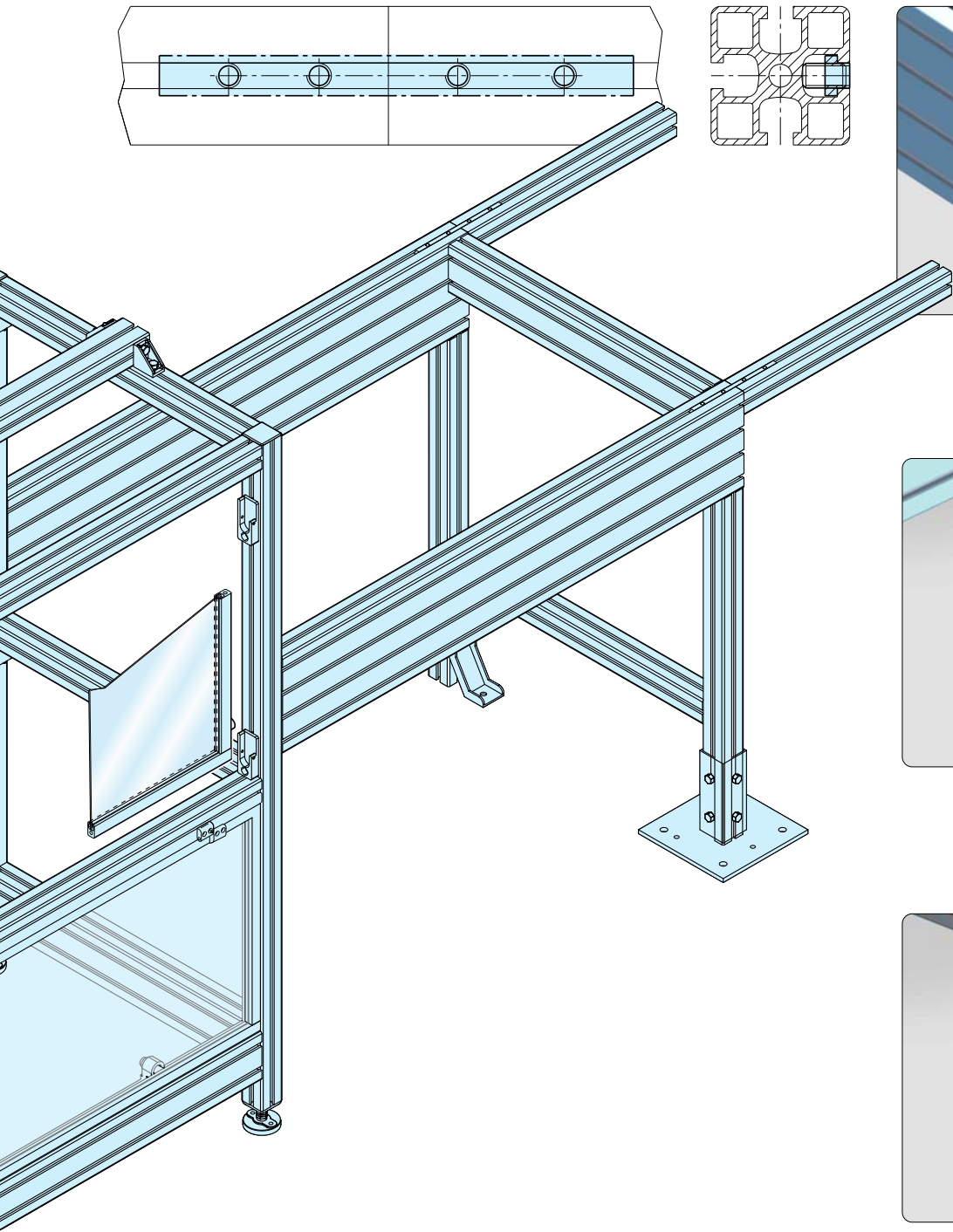

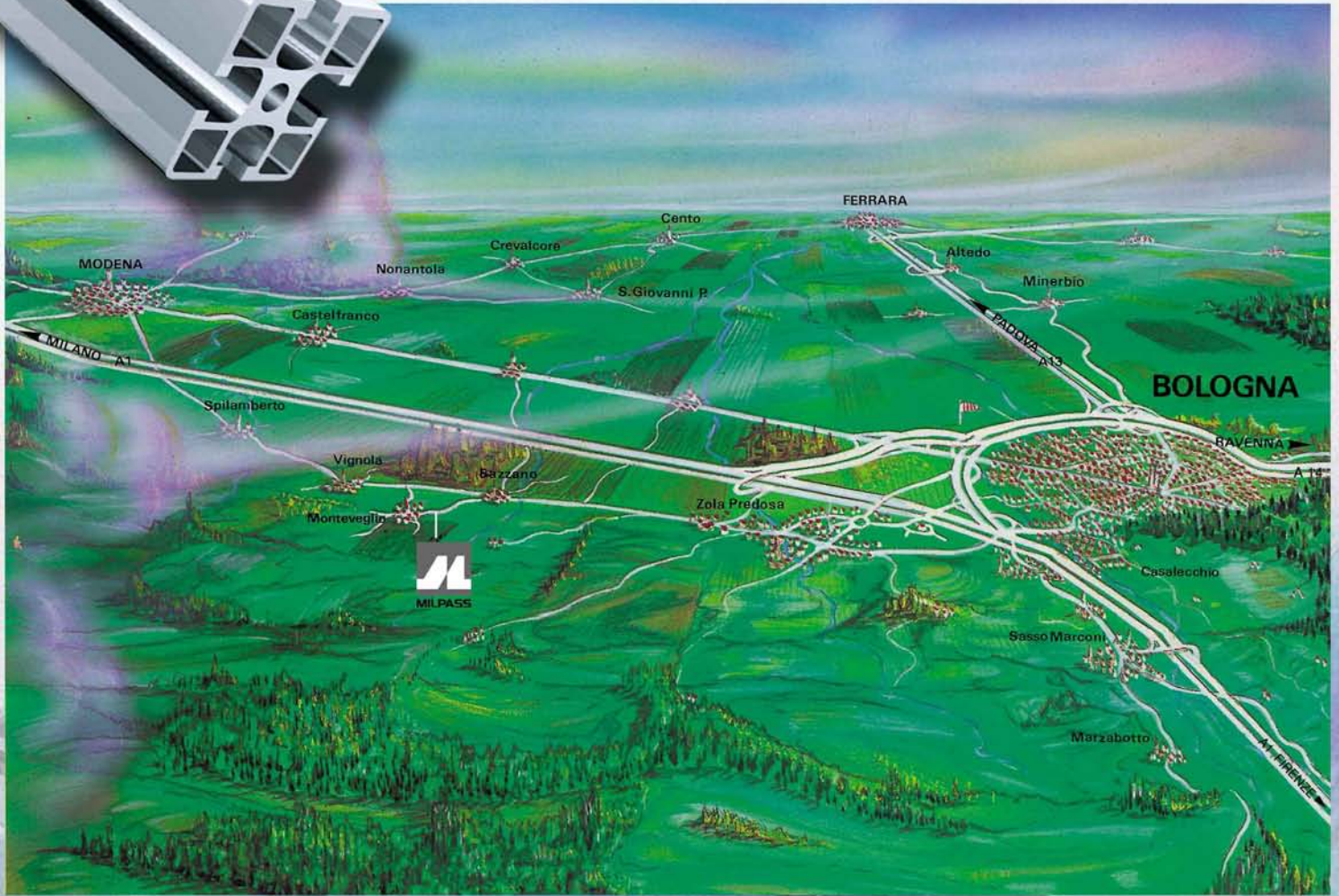

DALL'ESPERIENZA MILPASS, UNA LINEA DI PROFILI STRUTTURALI IN ALLUMINIO ANODIZZATO, CAVA 8 mm, COMPLETA DI ELEMENTI DI FISSAGGIO, DI GIUNZIONE, DI SOSTEGNO E DI TUTTI GLI ACCESSORI DI COMPLETAMENTO, UTILIZZABILI PER LA

- COMPOSIZIONE DI:
- STRUTTURE PORTANTI MODULARI
  - NASTRI TRASPORTATORI
  - BANCHI DI LAVORO
  - SISTEMI DI MOVIMENTAZIONE
  - STRUTTURE DI PROTEZIONE
  - BASAMENTI PER MACCHINE

THE EXPERIENCE MILPASS HAS GAINED HAS GIVEN RISE TO A LINE OF STRUCTURAL PROFILES MADE OF ANODIZED ALUMINIUM, SLOT 8 mm. COMPLETE WITH FASTENING, JOINT AND SUPPORT ELEMENTS AND A COMPREHENSIVE RANGE OF ACCESSORIES, WHICH CAN BE USED FOR THE COMPOSITION OF:

- MODULAR SUPPORT STRUCTURES
- CONVEYOR BELTS
- WORKBENCHES
- MOVEMENT AND HANDLING SYSTEMS
- PROTECTION STRUCTURES
- MACHINE BASES



**MILPASS**  
s.r.l.

40050 Monteveglio (BO) Italy  
via G. Deledda, 21  
Tel. (+39) 051 96 04 01  
Fax (+39) 051 96 06 18  
e-mail: [info@milpass.com](mailto:info@milpass.com)  
<http://www.milpass.com>  
<http://www.milpass.it>