

PULEGGE DENTATE POWERGRIP® PER CINGHIE POSITIVE

TIPO EXPORT "FOSFATE"

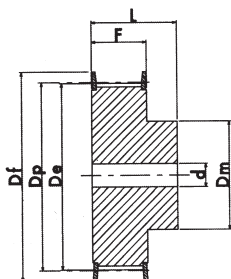

ESECUZIONE 1F

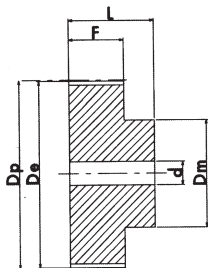

ESECUZIONE 2

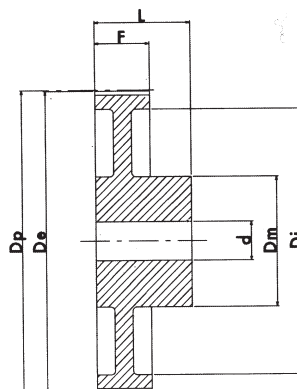

ESECUZIONE 3

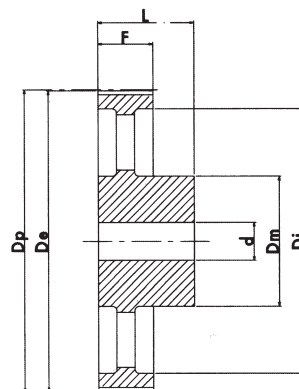

ESECUZIONE 4

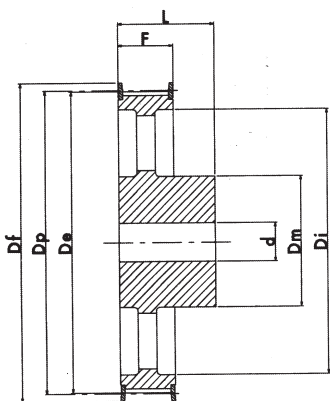

ESECUZIONE 5F

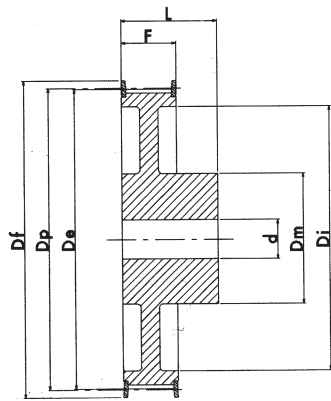

ESECUZIONE 6F

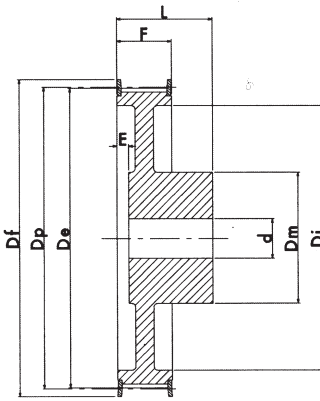

ESECUZIONE 7F

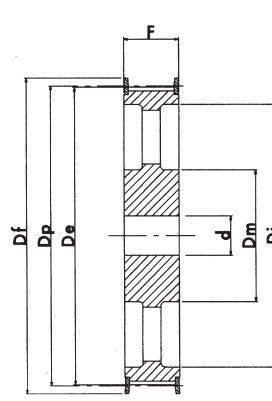

ESECUZIONE 8F

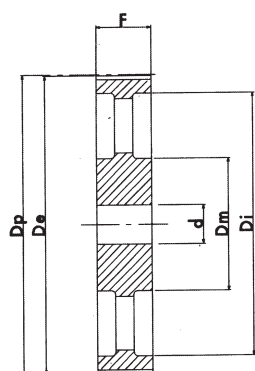

ESECUZIONE 9

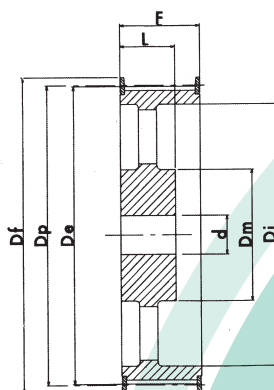

ESECUZIONE 10F

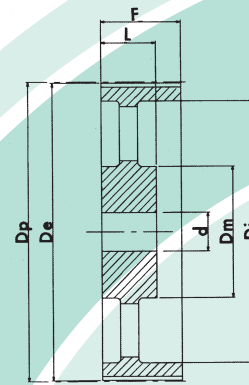

ESECUZIONE 11

PULEGGE DENTATE POWERGRIP® PER CINGHIE POSITIVE

TIPO EXPORT "FOSFATATE"

TIPO: L 075 Passo 3/8" (9.52mm.)

CARATTERISTICHE	TIPO	TIPO	N. DENTI	Dp PRIMITIVO	De ESTERNO	Df FLANGIA	Dm MOZZO	Di	F	L	d Ø foro	FLANGIA N.	
ACCIAIO	CON FLANGIA	10 L 075	1F	10	30.32	29.56	37	22	-	25	32	8	50
		12 L 075	1F	12	36.38	35.62	43	28	-	25	32	8	52
		13 L 075	1F	13	39.41	38.65	44	30	-	25	32	8	83
		14 L 075	1F	14	42.45	41.68	48	33	-	25	32	8	54
		15 L 075	1F	15	45.48	44.72	51	36	-	25	32	8	55
		16 L 075	1F	16	48.51	47.75	54	38	-	25	32	8	56
		17 L 075	1F	17	51.54	50.78	57	40	-	25	32	10	57
		18 L 075	1F	18	54.57	53.81	60	40	-	25.5	32	10	58
		19 L 075	1F	19	57.61	56.84	64	40	-	25	32	10	59
		20 L 075	1F	20	60.64	59.88	66.5	46	-	25	32	10	60
		21 L 075	1F	21	63.67	62.91	70	46	-	25	32	10	61
		22 L 075	1F	22	66.70	65.94	75	50	-	25	32	10	62
		24 L 075	1F	24	72.77	72.00	79	50	-	25	32	12	63
		26 L 075	1F	26	78.83	78.07	86	50	-	25	32	12	65
		28 L 075	1F	28	84.89	84.13	91	50	-	25	32	12	66
		30 L 075	1F	30	90.96	90.20	97	50	-	25	32	12	68
		32 L 075	1F	32	97.02	96.26	102	50	-	25	32	12	70
		36 L 075	6F	36	109.15	108.39	115	55	94	25	32	12	74
		40 L 075	6F	40	121.28	120.51	128	60	98	25	32	12	78
		GHISA	CON FLANGIA	44 L 075	5F	44	133.40	132.64	142	60	108	25	32
48 L 075	5F			48	145.53	144.77	150	60	118	25	32	12	85
SENZA FLANGIA	60 L 075		4	60	191.91	181.15	-	60	163	26	35	15	-
	72 L 075		4	70	218.30	217.53	-	60	199	26	35	15	-
	84 L 075		4	84	254.68	253.92	-	60	236	26	35	15	-

TIPO: L 100 Passo 3/8" (9.52mm.)

CARATTERISTICHE	TIPO	TIPO	N. DENTI	Dp PRIMITIVO	De ESTERNO	Df FLANGIA	Dm MOZZO	Di	F	L	d Ø foro	FLANGIA N.	
ACCIAIO	CON FLANGIA	10 L 100	1F	10	30.32	29.56	37	22	-	31	38	8	50
		12 L 100	1F	12	36.38	35.62	43	28	-	31	38	8	52
		13 L 100	1F	13	39.41	38.65	44	30	-	31	38	8	83
		14 L 100	1F	14	42.45	41.68	48	33	-	31	38	8	54
		15 L 100	1F	15	45.48	44.72	51	36	-	31	38	8	55
		16 L 100	1F	16	48.51	47.75	54	38	-	31	38	8	56
		17 L 100	1F	17	51.54	50.78	57	40	-	31	38	10	57
		18 L 100	1F	18	54.57	53.81	60	40	-	31	38	10	58
		19 L 100	1F	19	57.61	56.84	64	40	-	31	38	10	59
		20 L 100	1F	20	60.64	59.88	66.5	46	-	31	38	10	60
		21 L 100	1F	21	63.67	62.91	70	46	-	31	38	10	61
		22 L 100	1F	22	66.70	65.94	75	50	-	31	38	10	62
		24 L 100	1F	24	72.77	72.00	79	50	-	31	38	12	63
		26 L 100	1F	26	78.83	78.07	86	50	-	31	38	12	65
		28 L 100	1F	28	84.89	84.13	91	50	-	31	38	12	66
		30 L 100	1F	30	90.96	90.20	97	50	-	31	38	12	68
		32 L 100	1F	32	97.02	96.26	102	50	-	31	38	12	70
		36 L 100	7F	36	109.15	108.39	115	55	94	32	38	12	74
		40 L 100	7F	40	121.28	120.51	128	60	98	32	38	12	78
		GHISA	CON FLANGIA	44 L 100	8F	44	133.40	132.64	142	60	108	32	-
48 L 100	8F			48	145.53	144.77	150	60	118	32	-	12	85
SENZA FLANGIA	60 L 100		4	60	191.91	181.15	-	60	163	32	35	15	-
	72 L 100		4	72	218.30	217.53	-	60	199	32	35	15	-
	84 L 100		4	84	254.68	253.92	-	60	236	32	35	15	-

PULEGGE DENTATE POWERGRIP® PER CINGHIE POSITIVE

TIPO EXPORT "FOSFATATE"

TIPO: H 100 Passo 1/2" (12.7mm.)

CARATTERISTICHE	TIPO	ESEC..	N. DENTI	Dp PRIMITIVO	De ESTERNO	Df FLANGIA	Dm MOZZO	Di	F	L	E	d Ø foro	FLANGIA N.		
ACCIAIO	CON FLANGIA	14 H 100	14	56.60	55.22	64	40	-	31	41	-	10	59		
		16 H 100	16	64.68	63.31	70	46	-	31	41	-	10	61		
		18 H 100	18	72.77	71.39	79	54	-	31	41	-	12	63		
		19 H 100	19	76.81	75.44	82.5	58	-	31	41	-	12	64		
		20 H 100	20	80.85	79.48	87	62	-	31	41	-	12	76		
		21 H 100	21	84.89	83.52	91	67	-	31	41	-	12	66		
		22 H 100	22	88.94	87.56	94	70	-	31	41	-	12	67		
		24 H 100	24	97.02	95.65	102	75	-	31	41	-	12	70		
		26 H 100	26	105.11	103.73	112	55	81	32	40	8	15	72		
		28 H 100	28	113.19	111.82	115	60	88	32	40	8	15	75		
		30 H 100	30	121.28	119.90	128	60	97	32	40	8	15	78		
		32 H 100	32	129.36	127.99	135	70	105	32	40	-	20	80		
		36 H 100	36	145.53	144.16	150	80	118	32	40	-	20	85		
		GHISA	CON FLANGIA	40 H 100	40	161.70	160.33	168	80	135	32	40	-	20	90
				44 H 100	44	177.87	176.50	184	80	150	32	40	-	20	95
				48 H 100	48	194.04	192.67	200	80	170	32	40	-	20	100
SENZA FLANGIA	60 H 100		4	60	242.55	241.18	-	80	216	34	45	-	20	-	
	72 H 100		4	72	291.06	289.69	-	80	263	34	45	-	20	-	
	84 H 100		4	84	339.57	338.20	-	80	312	34	45	-	20	-	
	96 H 100		4	96	388.08	386.71	-	80	360	34	45	-	20	-	
	120 H 100		4	120	485.10	483.73	-	90	458	34	50	-	20	-	

TIPO: H 150 Passo 1/2" (12.7mm.)

CARATTERISTICHE	TIPO	ESEC..	N. DENTI	Dp PRIMITIVO	De ESTERNO	Df FLANGIA	Dm MOZZO	Di	F	L	E	d Ø foro	FLANGIA N.		
ACCIAIO	CON FLANGIA	14 H 150	14	56.60	55.22	64	40	-	44	54	-	12	59		
		16 H 150	16	64.68	63.31	70	46	-	44	54	-	12	61		
		18 H 150	18	72.77	71.39	79	54	-	44	54	-	12	63		
		19 H 150	19	76.81	75.44	82.5	58	-	44	54	-	12	64		
		20 H 150	20	80.85	79.48	87	62	-	44	54	-	12	76		
		21 H 150	21	84.89	83.52	91	67	-	44	54	-	12	66		
		22 H 150	22	88.94	87.56	94	70	-	44	54	-	12	67		
		24 H 150	24	97.02	95.65	102	75	-	44	54	-	12	70		
		26 H 150	26	105.11	103.73	112	55	81	45	53	18	15	72		
		28 H 150	28	113.19	111.82	115	60	88	45	53	18	15	75		
		30 H 150	30	121.28	119.90	128	60	97	45	53	18	15	78		
		32 H 150	32	129.36	127.99	135	70	105	45	53	-	20	80		
		36 H 150	36	145.53	144.16	150	80	118	45	53	-	20	85		
		GHISA	CON FLANGIA	40 H 150	40	161.7	160.33	168	80	135	45	-	-	20	90
				44 H 150	44	177.87	176.50	184	80	150	45	-	-	20	95
				48 H 150	48	194.04	192.67	200	80	170	45	-	-	20	100
SENZA FLANGIA	60 H 150		9	60	242.55	241.18	-	85	216	46	-	-	20	-	
	72 H 150		9	72	291.06	289.69	-	85	263	46	-	-	20	-	
	84 H 150		9	84	339.57	338.20	-	85	312	46	-	-	20	-	
	96 H 150		9	96	388.08	386.71	-	85	360	46	-	-	20	-	
	120 H 150		4	120	485.10	483.73	-	95	458	46	55	-	24	-	

PULEGGE DENTATE POWERGRIP® PER CINGHIE POSITIVE

TIPO EXPORT "FOSFATATE"

TIPO: H 200 Passo 1/2" (12.7mm.)

CARATTERISTICHE	TIPO	ESEC.	N. DENTI	Dp PRIMITIVO	De ESTERNO	Df FLANGIA	Dm MOZZO	Di	F	L	E	d Ø foro	FLANGIA N.	
ACCIAIO	CON FLANGIA	14 H 200	1F	14	56.60	55.22	64	40	-	58	68	-	-	59
		16 H 200	1F	16	64.68	63.31	70	46	-	58	68	-	-	61
		18 H 200	1F	18	71.77	71.39	79	54	-	58	68	-	-	63
		19 H 200	1F	19	76.81	75.44	82.5	58	-	58	68	-	-	64
		20 H 200	1F	20	80.85	79.48	87	62	-	58	68	-	-	76
		21 H 200	1F	21	84.89	83.52	91	67	-	58	68	-	-	66
		22 H 200	1F	22	88.94	87.56	94	70	-	58	68	-	-	67
		24 H 200	1F	24	97.02	95.65	102	75	-	58	68	-	-	70
		26 H 200	7F	26	105.11	103.73	112	60	81	58	66	24	15	72
		28 H 200	7F	28	113.19	111.82	115	60	88	58	66	24	15	75
		30 H 200	7F	30	121.28	119.90	128	70	97	58	66	24	15	78
		32 H 200	7F	32	129.36	127.99	135	70	105	58	66	19	20	80
		36 H 200	7F	36	145.53	144.16	150	80	118	58	66	19	20	85
GHISA	CON FLANGIA	40 H 200	10F	40	161.70	160.33	168	80	135	58	45	-	20	90
		44 H 200	10F	44	177.87	176.50	184	80	150	58	45	-	20	95
		48 H 200	10F	48	194.04	192.67	200	80	170	58	45	-	20	100
	SENZA FLANGIA	60 H 200	11	60	242.55	241.18	-	90	216	60	50	-	20	-
		72 H 200	11	72	291.06	289.69	-	90	263	60	50	-	20	-
		84 H 200	11	84	339.57	338.20	-	90	312	60	50	-	20	-
		96 H 200	11	96	388.08	386.71	-	90	360	60	50	-	20	-
		120 H 200	9	120	485.10	483.73	-	100	458	60	-	-	24	-

TIPO: H 300 Passo 1/2" (12.7mm.)

CARATTERISTICHE	TIPO	ESEC.	N. DENTI	Dp PRIMITIVO	De ESTERNO	Df FLANGIA	Dm MOZZO	Di	F	L	E	d Ø foro	FLANGIA N.	
ACCIAIO	CON FLANGIA	16 H 300	1F	16	64.68	63.31	70	46	-	84	94	-	-	61
		18 H 300	1F	18	71.77	71.39	79	54	-	84	94	-	-	63
		19 H 300	1F	19	76.81	75.44	82.5	58	-	84	94	-	-	64
		20 H 300	1F	20	80.85	79.48	87	62	-	84	94	-	-	76
		21 H 300	1F	21	84.89	83.52	91	67	-	84	94	-	-	66
		22 H 300	1F	22	88.94	87.56	94	70	-	84	94	-	-	67
		24 H 300	1F	24	97.02	95.65	102	75	-	84	94	-	-	70
		26 H 300	7F	26	105.11	103.73	112	60	81	84	92	35	15	72
		28 H 300	7F	28	113.19	111.82	115	60	88	84	92	35	15	75
		30 H 300	7F	30	121.28	119.90	128	70	97	84	92	35	15	78
		32 H 300	7F	32	129.36	127.99	135	70	105	84	92	35	20	80
		36 H 300	7F	36	145.53	144.16	150	80	118	84	92	35	20	85
		GHISA	CON FLANGIA	40 H 300	10F	40	161.70	160.33	168	80	135	84	55	-
44 H 300	10F			44	177.87	176.50	184	80	150	84	55	-	20	95
48 H 300	10F			48	194.04	192.67	200	85	170	84	55	-	20	100
SENZA FLANGIA	60 H 300		11	60	242.55	241.18	-	100	216	86	55	-	20	-
	72 H 300		11	72	291.06	289.69	-	100	263	86	55	-	20	-
	84 H 300		11	84	339.57	338.20	-	100	312	86	55	-	20	-
	96 H 300		11	96	388.08	386.71	-	100	360	86	55	-	20	-
	120 H 300		11	120	485.10	483.73	-	110	458	86	65	-	24	-