

Serie/Series **57000**

**RACCORDI AD INNESTO AUTOMATICO CON  
SPINTORE IN METALLO**  
*PUSH-IN FITTINGS WITH METAL COLLET*

## Caratteristiche Tecniche | Technical Characteristics



## Materiali e Componenti | Component Parts and Materials

- |  |  |
|--|--|
| 1 Corpo in Ottone Nichelato                        | 1 Nickel-plated brass Body                 |
| 2 Spintore sgancio tubo in Ottone Nichelato        | 2 Nickel-plated brass Collet               |
| 3 Capsula in ottone nichelato                      | 3 Nickel-plated brass Capsule              |
| 4 Pinza d'aggraffaggio in acciaio inox aisi 304    | 4 Steel aisi 304 Clamping washer           |
| 5 Anello di sicurezza in Tecnopolimero             | 5 Technopolymeric Safety ring              |
| 6 Guarnizione a labbro in NBR 70 (FKM a richiesta) | 6 Nbr 70 Lip seal (if requested FKM)       |
| 7 Guarnizione filetto in NBR 70 (FKM a richiesta)  | 7 Nbr 70 Thread packing (if requested FKM) |

## Pressioni | Pressures

Pressione minima / Minimum pressure: **-0.99 bar** (-0.099 MPa)  
 Pressione massima / Maximum pressure: **15 bar** (1.5 MPa)

## Temperature | Temperatures

Temperatura minima / Minimum temperature: **-20 °C**  
 Temperatura massima / Maximum temperature: **+80 °C**

## Filettature | Threads

Filettatura conica "short" / "Short" taper thread.  
 Gas conica conforme ISO 7.1, BS 21, DIN 2999 / Tapered gas in conformity with ISO 7.1, BS 21, DIN 2999.  
 Gas cilindrica conforme ISO 228 Classe A / Parallel gas in conformity with ISO 228 Class A.

## Tubi di collegamento | Connection Tubes

Tubi in materiale plastico:  
 PA6, PA11, PA12, Polietilene, \*Poliuretano; ecc.  
 \*Per tubi in Poliuretano é consigliata una durezza di 98 shore.  
 Plastic tubes:  
 PA6, PA11, PA12, Polyethylene, \*Polyurethane, ecc.  
 \*For Polyurethane hoses it is required a minimum hardness of 98 shore.

## Fluidi compatibili | Fluids

Aria compressa / Compressed air.  
 Vuoto / Vacuum  
 Vapore con o-ring FKM / Steam with FKM o-ring  
 Acqua / Water

*Le Principali Caratteristiche | The Most Important Characteristics*

**La pinza in acciaio inox garantisce il perfetto aggraffaggio di tubi di qualsiasi materiale senza danneggiarne la superficie.**

*The collet made in stainless steel ensure the perfect tube clamping with every kinds of materials without damage the surface.*

**Il collegamento tra tubo e raccordo assicura una tenuta totale anche in condizioni di urti e vibrazioni.**

*The connection between the tube and the fitting ensure a total tightness even in severe conditions such as impact and vibrations.*

**La particolare geometria della guarnizione permette inoltre l'utilizzo dei raccordi anche con il vuoto.**

*The particular geometric shape of the seal ensure the perfect tightness even with vacuum.*



**Anello di tenuta per filetti conici.**

**O-Ring di tenuta per filetti cilindrici.**

*Thread packing for the taper threads.*

*O-Ring for the parallel threads.*

**Tutte le filettature di questa serie (anche la misura da M5) sono state dotate di elementi di tenuta che permettono l'immediato utilizzo dei raccordi riducendo notevolmente i tempi di installazione.**

*All of threads from this range (also the M5), have been equipped with tightening parts which allow the direct assembly of the fittings, reducing the installation time.*

**Tutti i raccordi dritti, con filettature coniche o cilindriche, possono essere montati anche con chiave esagonale ed è possibile utilizzarli anche in spazi molto ridotti.**

*All the straight fittings, with taper and parallel threads can be assembled also with Allen wrench and it is possible to use them in reduced spaces.*



**COME ORDINARE**

Tutti gli articoli standard della Serie 57000 subiscono un trattamento superficiale di NICHELATURA.

Per formulare un ordine é sufficiente specificare ARTICOLO, MISURA, QUANTITA'.

**HOW TO ORDER**

All the standard items of the 57000 series undergo to a surface treatment of nickel plating.

To order simply specify the ARTICLE CODE, SIZE and QUANTITY.

# 57020

RACCORDO DIRITTO MASCHIO CILINDRICO - STRAIGHT MALE ADAPTOR (PARALLEL)

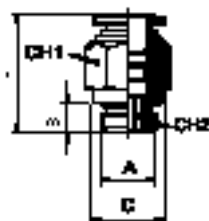

Tubo Tube	A	B	C	L	CH1	CH2	Conf. Pack.
4 - M5	4	8	21	10	2	25	
4 - 1/8	6	13	20	10	3	25	
4 - 1/4	8	16	19.5	16	3	25	
5 - M5	4	8	23.5	12	2	25	
5 - 1/8	6	13	22	12	4	25	
6 - M5	4	10	24.5	13	2	25	
6 - 1/8	6	13	23.5	13	4	25	
6 - 1/4	8	16	23.5	13	4	25	
6 - 3/8	9	20	25	13	4	25	
6 - 1/2	10	25	27	13	4	25	
8 - 1/8	6	13	25	14	5	25	
8 - 1/4	8	16	23	14	6	25	
8 - 3/8	9	20	24	14	6	25	
8 - 1/2	10	25	26.5	14	6	25	
10 - 1/4	8	16	30.5	17	6	25	
10 - 3/8	9	20	27.5	17	8	25	
10 - 1/2	10	25	27	17	8	25	
12 - 1/4	8	16	34.5	20	6	25	
12 - 3/8	9	20	34	20	8	25	
12 - 1/2	10	25	31	22	10	10	
14 - 3/8	9	20	35	21	10	10	
14 - 1/2	10	25	32	22	10	10	
6 - M12x1	8	15	23.5	13	4	25	
6 - M12x1.25	8	15	23.5	13	4	25	
6 - M12x1.5	8	15	23.5	13	4	25	
8 - M12x1.5	8	15	27.5	14	6	25	



5 7 0 2 0

8 - 1/4

CODICE ARTICOLO  
ARTICLE CODE

MISURA  
SIZE

# 57010

RACCORDO DIRITTO MASCHIO SHORT ESAGONO INCASSATO - STRAIGHT MALE ADAPTOR (SHORT) WITH EXAGON EMBEDDED

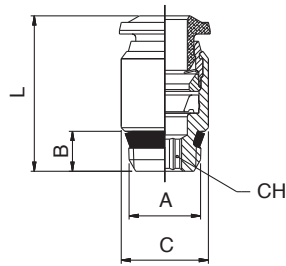

Tubo Tube	A	B	C	L	CH	Conf. Pack.
4	- M5	4	10	21	2.5	25
4	- 1/8	7.5	10	19	3	25
4	- M7x1	5	10	21	2.5	25
6	- M5	4	12	24.5	2.5	25
6	- 1/8	7.5	12	22.5	4	25
6	- 1/4	11	14	24.5	4	25
8	- 1/8	7.5	14	25.5	5	25
8	- 1/4	11	14	25	6	25

# 57020

RACCORDO DIRITTO MASCHIO CILINDRICO - STRAIGHT MALE ADAPTOR (PARALLEL)

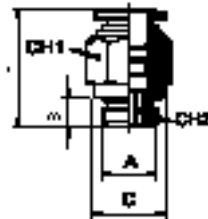

Tubo Tube	A	B	C	L	CH1	CH2	Conf. Pack.
4	- M5	4	8	21	10	2	25
4	- 1/8	6	13	20	10	3	25
4	- 1/4	8	16	19.5	16	3	25
5	- M5	4	8	23.5	12	2	25
5	- 1/8	6	13	22	12	4	25
6	- M5	4	10	24.5	13	2	25
6	- 1/8	6	13	23.5	13	4	25
6	- 1/4	8	16	23.5	13	4	25
6	- 3/8	9	20	25	13	4	25
6	- 1/2	10	25	27	13	4	25
8	- 1/8	6	13	25	14	5	25
8	- 1/4	8	16	23	14	6	25
8	- 3/8	9	20	24	14	6	25
8	- 1/2	10	25	26.5	14	6	25
10	- 1/4	8	16	30.5	17	6	25
10	- 3/8	9	20	27.5	17	8	25
10	- 1/2	10	25	27	17	8	25
12	- 1/4	8	16	34.5	20	6	25
12	- 3/8	9	20	34	20	8	25
12	- 1/2	10	25	31	22	10	10
14	- 3/8	9	20	35	21	10	10
14	- 1/2	10	25	32	22	10	10
6	- M12x1	8	15	23.5	13	4	25
6	- M12x1.25	8	15	23.5	13	4	25
6	- M12x1.5	8	15	23.5	13	4	25
8	- M12x1.5	8	15	27.5	14	6	25

# 57030

RACCORDO DIRITTO FEMMINA - STRAIGHT FEMALE ADAPTOR

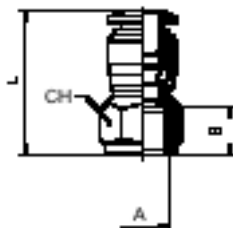

Tubo Tube	A	B	L	CH	Conf. Pack.
4	- M5	5.5	21	11	25
4	- 1/8	8.5	24	13	25
4	- 1/4	11	27.5	16	25
5	- 1/8	8.5	26.5	13	25
6	- 1/8	8.5	26	13	25
6	- 1/4	11	29.5	16	25
8	- 1/8	8.5	27	15	25
8	- 1/4	11	29.5	17	25
8	- 3/8	12	32	19	25
10	- 1/4	11	32	18	25
10	- 3/8	12	33.5	19	25
10	- 1/2	15	39	24	25
12	- 3/8	12	36	21	25
12	- 1/2	15	41	24	25

# 57040

RACCORDO DIRITTO INTERMEDIO - STRAIGHT CONNECTOR



Tubo Tube	L	B	Conf. Pack.
4	30.5	10.5	25
5	33	11.5	25
6 - 4	32	12.5	25
6	34	12.5	25
8 - 6	35	14.5	25
8	36	14.5	25
10 - 8	40.5	17.5	25
10	42	17.5	25
12 - 10	45.5	20.5	25
12	47	20.5	25
14	49	21.5	10



# 57050

RACCORDO DIRITTO INTERMEDIO DI ATTRAVERSAMENTO - BULKHEAD CONNECTOR

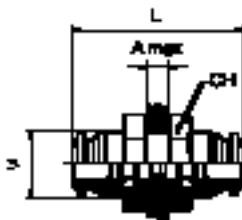

Tubo Tube	M	L	CH	A <sub>max</sub>	Conf. Pack.
4 - M12x1	M12x1	31.5	17	7	25
5 - M14x1	M14x1	33	17	7	25
6 - M14x1	M14x1	35	17	9.5	25
8 - M16x1	M16x1	37	19	10.5	25
10 - M20x1	M20x1	43	24	12.5	25
12 - M22x1	M22x1	48	26	16.5	25



# 57100

RACCORDO A L MASCHIO CONICO - ELBOW MALE ADAPTOR (TAPER)

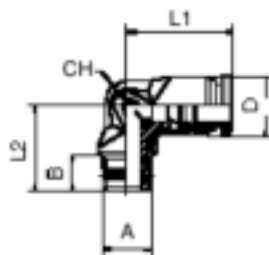

Tubo Tube	A	B	L1	L2	CH	D	Conf. Pack.
4 - M5	M5	5	17	15	9	10	25
4 - 1/8	1/8	7.5	17	15.5	9	10	25
5 - M5	M5	5	20	17	11	12.5	25
5 - 1/8	1/8	7.5	20	17.5	11	12.5	25
6 - 1/8	1/8	7.5	21	17.5	11	12.5	25
6 - 1/4	1/4	11	21	21.5	11	12.5	25
8 - 1/8	1/8	7.5	22.5	19	13	14	25
8 - 1/4	1/4	11	22.5	21.5	13	14	25
10 - 1/4	1/4	11	26.5	24.5	16	17	25
10 - 3/8	3/8	11.5	26.5	24	16	17	25
12 - 1/4	1/4	11	30.5	28	19	21.5	25
12 - 3/8	3/8	11.5	30.5	28	19	21.5	25



# 57106

RACCORDO A L FEMMINA ORIENTABILE - ORIENTING ELBOW FEMALE ADAPTOR

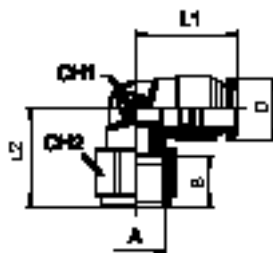

Tubo Tube	A	B	L1	L2	CH1	CH2	D	Conf. Pack.
4 - 1/8	1/8	8.5	18	17.2	9	13	10	25
4 - 1/4	1/4	11	18	19.7	9	16	10	25
6 - 1/8	1/8	8.5	21	18.9	11	13	12.5	25
6 - 1/4	1/4	11	21	21.4	11	16	12.5	25
8 - 1/8	1/8	8.5	22.5	20.4	12	13	14.5	25
8 - 1/4	1/4	11	22.5	22.9	12	16	14.5	25



# 57116

RACCORDO A L ORIENTABILE MASCHIO CILINDRICO - ORIENTING ELBOW MALE ADAPTOR (PARALLEL)

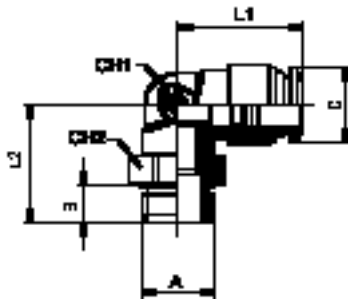

Tube	A	B	L1	L2	CH1	CH2	D	Conf. Pack.
4	M5	3.6	18	16.1	9	8	10	25
4	1/8	5.4	18	16.4	9	13	10	25
4	1/4	7.1	18	18.1	9	16	10	25
5	M5	3.6	20	18.3	11	11	12.5	25
5	1/8	5.4	20	18.1	11	13	12.5	25
6	M5	3.6	21	18.3	11	11	12.5	25
6	1/8	5.4	21	18.1	11	13	12.5	25
6	1/4	7.1	21	19.8	11	16	12.5	25
8	1/8	5.4	22.5	21.1	12	13	14.5	25
8	1/4	7.1	22.5	21.3	12	16	14.5	25
8	3/8	8.1	22.5	23.3	12	20	14.5	25
8	1/2	9.6	22.5	24.8	12	25	14.5	25
10	1/4	7.1	26.5	25.3	14	16	17.5	25
10	3/8	8.1	26.5	24.8	14	20	17.5	25
10	1/2	9.6	26.5	26.3	14	25	17.5	25
12	3/8	8.1	31.3	26.8	16	20	21.5	25
12	1/2	9.6	31.3	28.3	16	25	21.5	25
14	3/8	8.1	31.3	27.3	16	20	21.5	10
14	1/2	9.6	31.3	28.8	16	25	21.5	10
6	M12x1	7.3	20	20.6	11	16	12.5	25
6	M12x1.25	7.3	20	21.7	11	16	12.5	25
6	M12x1.5	7.3	20	21.7	11	16	12.5	25
8	M12x1.5	7.3	22.5	22.2	12	16	14.5	25



# 57126

RACCORDO A L ORIENTABILE PROLUNGATO MASCHIO CILINDRICO - EXTENDED ORIENTING ELBOW MALE ADAPTOR (PARALLEL)

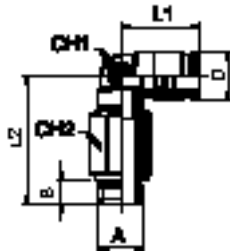

Tube	A	B	L1	L2	CH1	CH2	D	Conf. Pack.
4	1/8	5.4	18	28.4	9	12	10	25
4	1/4	7.1	18	30.1	9	15	10	25
5	1/8	5.4	20	32.6	11	12	12.5	25
6	1/8	5.4	21	32.6	11	12	12.5	25
6	1/4	7.1	21	34.3	11	15	12.5	25
8	1/8	5.4	22.8	37.6	12	12	14.5	25
8	1/4	7.1	22.5	37.8	12	15	14.5	25
8	3/8	8.1	22.5	39.8	12	18	14.5	25
10	1/4	7.1	26.5	45	14	16	17.5	25
10	3/8	8.1	26.5	44.3	14	18	17.5	25



# 57130

RACCORDO A L INTERMEDIO - ELBOW CONNECTOR



Tube	L	CH	D	Conf. Pack.
4	17	9	10	25
5	20	11	12.5	25
6	21	11	12.5	25
8	22.5	13	14	25
10	26.5	16	17	25
12	30.5	19	21.5	25
14	32.5	19	21.5	10



# 57200

RACCORDO A T MASCHIO CONICO - TEE MALE ADAPTOR (TAPER) CENTRE LEG

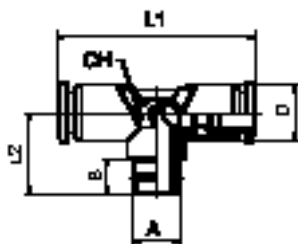

Tube	A	B	L1	L2	CH	D	Conf. Pack.
4 - M5		5	34	15	9	10	25
4 - 1/8		7.5	34	15.5	9	10	25
5 - 1/8		7.5	40	17.5	11	12.5	25
6 - 1/8		7.5	42	17.5	11	12.5	25
8 - 1/8		7.5	45	19	13	14	25
8 - 1/4		11	45	21.5	13	14	25
10 - 1/4		11	53	24.5	16	17	25
10 - 3/8		11.5	53	24	16	17	25
12 - 1/4		11	61	28	19	21.5	10
12 - 3/8		11.5	61	28	19	21.5	10

# 57216

RACCORDO A T ORIENTABILE MASCHIO CILINDRICO - ORIENTING TEE MALE ADAPTOR (PARALLEL) CENTRE LEG

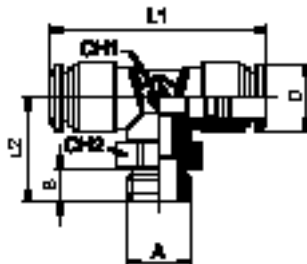

Tube	A	B	L1	L2	CH1	CH2	D	Conf. Pack.
4 - M5		3.6	34	16.8	9	8	10	25
4 - 1/8		5.4	34	17.1	9	13	10	25
4 - 1/4		7.1	34	18.8	9	16	10	25
5 - M5		3.6	40	18.3	11	11	12.5	25
5 - 1/8		5.4	40	18.1	11	13	12.5	25
6 - M5		3.6	42	18.6	11	11	12.5	25
6 - 1/8		5.4	42	18.4	11	13	12.5	25
6 - 1/4		7.1	42	20	11	16	12.5	25
8 - 1/8		5.4	45	23.7	13	13	14.5	25
8 - 1/4		7.1	45	24	13	16	14.5	25
8 - 3/8		8.1	45	26	13	20	14.5	25
8 - 1/2		9.6	45	27.4	13	25	14.5	25
10 - 1/4		7.1	53	27.7	14	16	17.5	25
10 - 3/8		8.1	53	27.2	14	20	17.5	25
10 - 1/2		9.6	53	28.7	14	25	17.5	25
12 - 3/8		8.1	62.6	29.4	16	20	21.5	10
12 - 1/2		9.6	62.6	30.9	16	25	21.5	10
14 - 3/8		8.1	62.6	29.4	16	20	21.5	10
14 - 1/2		9.6	62.6	30.9	16	25	21.5	10
6 - M12x1		7.3	42	21.3	11	16	12.5	25
6 - M12x1.25		7.3	42	21.3	11	16	12.5	25
6 - M12x1.5		7.3	42	21.3	11	16	12.5	25

# 57226

RACCORDO A T ORIENTABILE MASCHIO LATERALE CILINDRICO - ORIENTING TEE MALE ADAPTOR (PARALLEL) OFF - SET LEG

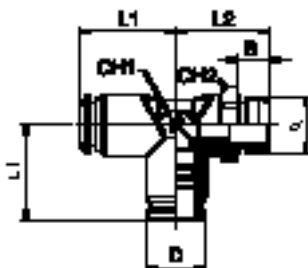

Tube	A	B	L1	L2	CH1	CH2	D	Conf. Pack.
4 - M5		3.6	17	16.1	9	8	10	25
4 - 1/8		5.4	17	16.4	9	13	10	25
4 - 1/4		7.1	17	18.1	9	16	10	25
5 - M5		3.6	20	18.3	11	11	12.5	25
5 - 1/8		5.4	20	18.1	11	13	12.5	25
6 - M5		3.6	21	18.3	11	11	12.5	25
6 - 1/8		5.4	21	18.1	11	13	12.5	25
6 - 1/4		7.1	21	19.8	11	16	12.5	25
8 - 1/8		5.4	22.5	22.6	13	13	14.5	25
8 - 1/4		7.1	22.5	22.8	13	16	14.5	25
8 - 3/8		8.1	22.5	24.8	13	20	14.5	25
8 - 1/2		9.6	22.5	26.3	13	25	14.5	25
10 - 1/4		7.1	26.5	26.8	14	16	17.5	25
10 - 3/8		8.1	26.5	26.3	14	20	17.5	25
10 - 1/2		9.6	26.5	27.8	14	25	17.5	25
12 - 3/8		8.1	31.3	29.4	16	20	21.5	10
12 - 1/2		9.6	31.3	30.9	16	25	21.5	10
6 - M12x1		7.3	21	21	11	16	12.5	25
6 - M12x1.25		7.3	21	21	11	16	12.5	25
6 - M12x1.5		7.3	21	21	11	16	12.5	25

# 57230

RACCORDO A T INTERMEDIO - TEE CONNECTOR

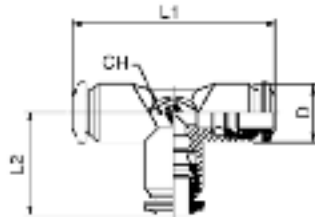

Tubo Tube	L1	L2	CH	D	Conf. Pack.
<b>4</b>	34	17	9	10	25
<b>5</b>	40	20	11	12.5	25
<b>6</b>	42	21	11	12.5	25
<b>8</b>	45	22.5	13	14	25
<b>10</b>	53	26.5	16	17	25
<b>12</b>	61	30.5	19	21.5	10
<b>14</b>	65.5	32.5	19	21.5	10

# 57310

RACCORDO A Y INTERMEDIO - Y CONNECTOR

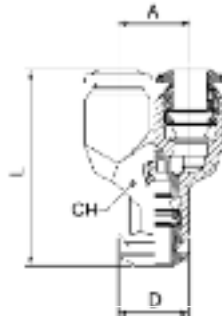

Tubo Tube	A	L	CH	D	Conf. Pack.
<b>4</b>	11	32	9	10	25
<b>5</b>	13.5	35	11	12.5	25
<b>6</b>	13.5	36.5	11	12.5	25
<b>8</b>	15.5	41	13	14	25
<b>10</b>	18.5	48	18	17	10

# 57500

ANELLO ORIENTABILE A L - SINGLE BANJO BODY

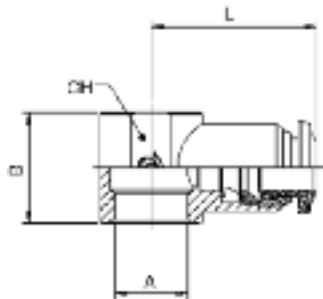

Tubo Tube	A	B	L	CH	D	Conf. Pack.
<b>4</b> - <b>M5</b>	12.5	19	-	10	25	
<b>4</b> - <b>M6</b>	12.5	19	-	10	25	
<b>4</b> - <b>1/8</b>	15	21	14	10	25	
<b>5</b> - <b>M5</b>	12.5	20	-	12.5	25	
<b>5</b> - <b>M6</b>	12.5	20	-	12.5	25	
<b>5</b> - <b>1/8</b>	15	21.5	14	12.5	25	
<b>5</b> - <b>1/4</b>	17	24.5	18	12.5	25	
<b>6</b> - <b>M5</b>	12.5	20.5	-	12.5	25	
<b>6</b> - <b>M6</b>	12.5	20.5	-	12.5	25	
<b>6</b> - <b>1/8</b>	15	22	14	12.5	25	
<b>6</b> - <b>1/4</b>	17	25	18	12.5	25	
<b>8</b> - <b>1/8</b>	15	24	14	14	25	
<b>8</b> - <b>1/4</b>	17	26	18	14	25	
<b>8</b> - <b>3/8</b>	20	28	21	14	25	
<b>10</b> - <b>1/4</b>	17	29	18	17	25	
<b>10</b> - <b>3/8</b>	20	30.5	21	17	25	
<b>12</b> - <b>3/8</b>	20	32.5	21	21.5	25	
<b>12</b> - <b>1/2</b>	24	35	25	21.5	25	
<b>14</b> - <b>1/2</b>	24	35.5	25	21.5	10	

# 57505

ANELLO ORIENTABILE A L - SINGLE BANJO BODY

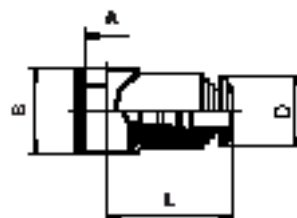

Tubo Tube	A	B	L	D	Conf. Pack.
<b>4</b> - <b>M6</b>	12.5	19	10	10	10
<b>5</b> - <b>M6</b>	12.5	20	12.5	10	10
<b>6</b> - <b>M6</b>	12.5	20.5	12.5	10	10

Questo articolo è prodotto appositamente per Regolatori di Portata da M5.

*This article has been produced suitably for the Adjustable Restrictor valves M5.*

# 57510

ANELLO ORIENTABILE A T - DOUBLE BANJO BODY



Tubo Tube	A	B	L	CH	D	Conf. Pack.
4	- M5	12.5	38	-	10	25
4	- M6	12.5	38	-	10	25
4	- 1/8	15	42	14	10	25
5	- 1/8	15	43	14	12.5	25
5	- 1/4	17	49	18	12.5	25
6	- 1/8	15	44	14	12.5	25
6	- 1/4	17	50	18	12.5	25
8	- 1/8	15	48	14	14	25
8	- 1/4	17	52	18	14	25

# 57550

RACCORDO A L ORIENTABILE MASCHIO CILINDRICO - ORIENTING SINGLE BANJO BODY MALE

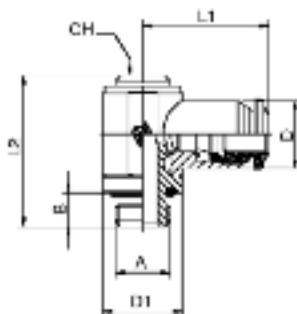

Tubo Tube	A	B	L1	L2	CH	D1	D	Conf. Pack.
4	- M5	5	19	24.5	-	9	10	25
4	- 1/8	6	21	27	5	14	10	25
5	- M5	5	20	24.5	-	9	12.5	25
5	- 1/8	6	21.5	27	5	14	12.5	25
5	- 1/4	8	24.5	31	6	18	12.5	25
6	- M5	5	20.5	24.5	-	9	12.5	25
6	- 1/8	6	22.5	27	5	14	12.5	25
6	- 1/4	8	25	31	6	18	12.5	25
8	- 1/8	6	24	27	5	14	14	25
8	- 1/4	8	26	31	6	18	14	25
8	- 3/8	9	28	35.5	7	21	14	25
10	- 1/4	8	29	31	6	18	17	25
10	- 3/8	9	30.5	35.5	7	21	17	25
12	- 3/8	9	32.5	35.5	7	21	21.5	25

# 57560

RACCORDO A T ORIENTABILE MASCHIO CILINDRICO - ORIENTING DOUBLE BANJO BODY MALE

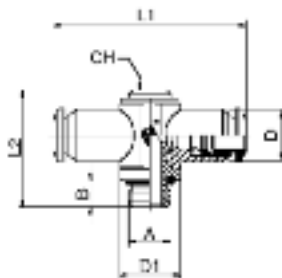

Tubo Tube	A	B	L1	L2	D1	CH	D	Conf. Pack.
4	- M5	5	38	24.5	9	-	10	25
4	- 1/8	6	42	27	14	5	10	25
5	- 1/8	6	43	27	14	5	12.5	25
5	- 1/4	8	49	31	18	6	12.5	25
6	- 1/8	6	45	27	14	5	12.5	25
6	- 1/4	8	50	31	18	6	12.5	25
8	- 1/8	6	48	27	14	5	14	25
8	- 1/4	8	52	31	18	6	14	25

# 57700

RIDUZIONE - REDUCER

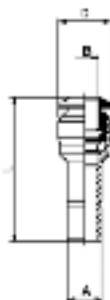

A	B	L	D	Conf. Pack.
5	- 4	29	12.5	25
6	- 4	30	12.5	25
6	- 5	32	12.5	25
8	- 4	33	14	25
8	- 6	34	14	25
10	- 4	32	17	25
10	- 8	38	17	25
12	- 8	39	21.5	25